



Design



Manufacturing



Supply



Install & Service

Laboratory Furniture for Industries

product catalogue





METROLABS

Lab Furniture | Fume Hood | Anti-Vibration Table | Storage Cupboards

Since 2000, Metrolabs designed, manufactured supply and installed laboratory furniture, fume hoods, anti-vibration table bio safety cabinets, laminar airflow for educational institutes and industries.



Contents

Note:
Images in this catalog are for representation only. For complete product specifications,
contact your Metrolabs Customer Service Executive

cabinet specifications

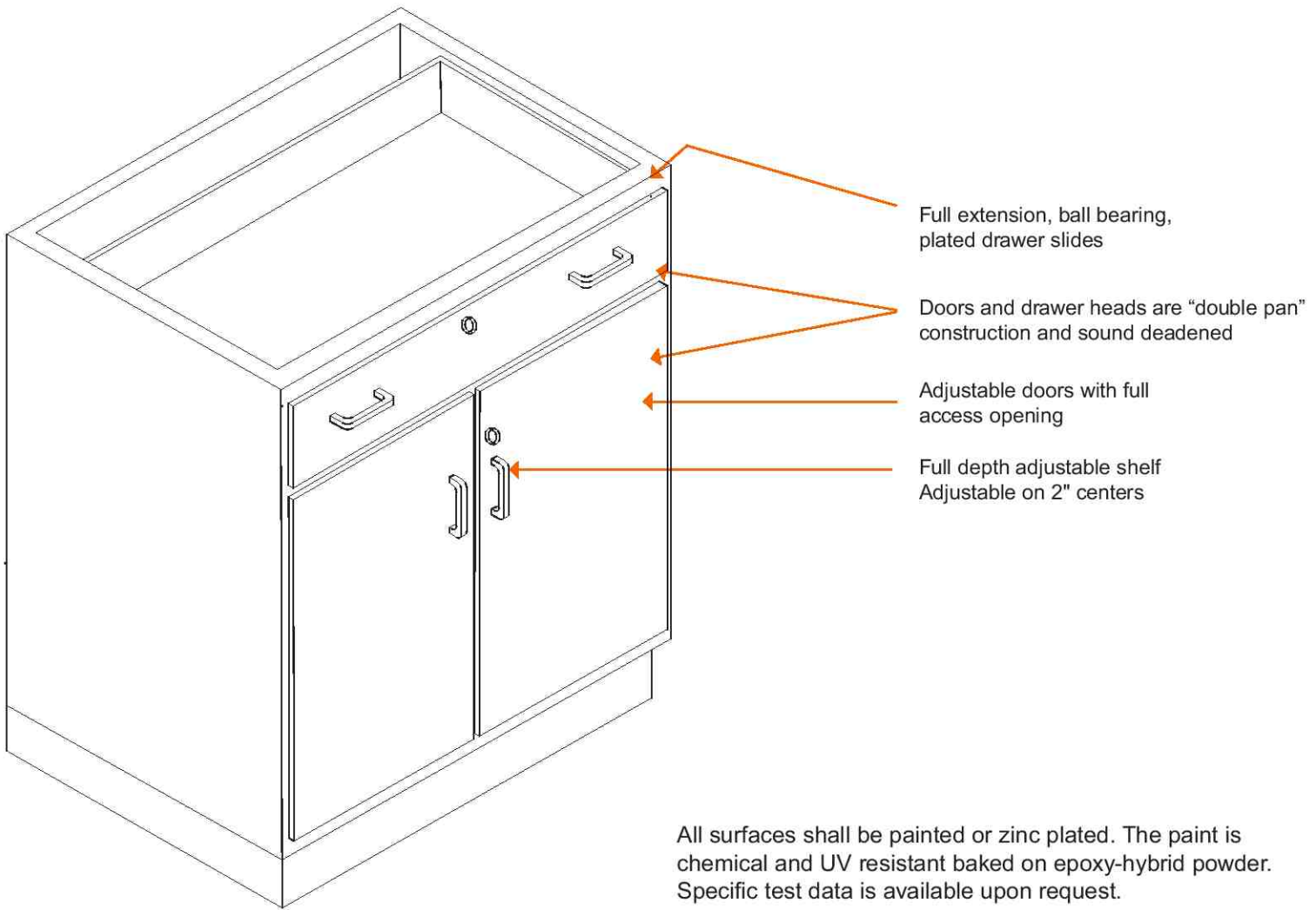

Gauges of base cabinet components

Back Panels	1 mm thick.
Bottom Panels	1 mm thick.
Drawer/Door Outer Panel	1 mm thick.
Door Inner Panel	1 mm thick.
Drawer Bodies	1 mm thick.
Bottom	1 mm thick.
Shelves	1 mm thick.

For complete specifications, request our full line of product specifications. Subject to change.

options menu

door and drawer fronts



Single Door Modules (SDM)



Double Door Module (DDM)

without drawer - only doors

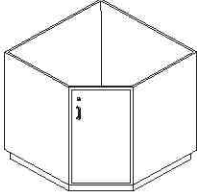

Corner Single Door Module (CSDM)

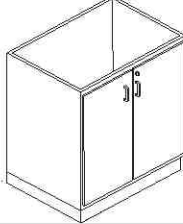

Without Draw Module (NDDM)

three and four draw modules

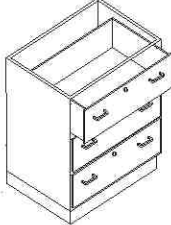

Three draw module (3DM)



Four draw Module (4DM)

two draw module



Two draw Module (2DM)

locks



Cam Lock

options menu

hinges



Silent System soft closure
(Standard Default)



Butt Hinges Ball Bearing
(on customer request)

handles



D type Handle
(Standard Default)



Pull Cabinet Handles
(on customer request)

label holders



Soft-Close Drawer Slides
(Standard Default)



Bottom Mount Drawer Slide Set
(on customer request)

doors alignment



Out side projected
(Standard Default)



Inner side
(on customer request)

options menu

design

dimensions of the lab
 width length of the required furniture, if known.
 electrical points and water sinks required details
 list of tests planed in the future laboratory

manufacturing

Fabrication - Sheet marking - Sheet Cutting/ Pipe cutting - Part fabrication - Assembly
 Powder coating - Surface preparation - Putty work - overall powder coating -
 Heat chamber - Drying.
 Storage - Finished furniture storage

supply

proper packaging - transportation

install & service

arrange the units according to the installation drawings
 locate the high point in the floor by leveling across the tops of the units
 installed in a high quality, fast and accurate manner.

The repair work of furniture items will be carried out.
 we offer buy back steel furniture, Fume hoods etc.

lab furniture

fume hoods

anti-vibration table

storage cupboards

work table

table with sink

reagent rack

power socket

laminar air flow

wooden top lab stools

anti-vibration table

fume hood and extractoers

storage cupboard

storage racks

bio-safety cabinets

vibration free table

options menu

Work Top	(I) Made of polished (18±1mm) thick Black Granite top with quad moulding at the front and groove at the bottom to avoid chemical spillage on the modules (optional). (II) 16 mm thick Polymer resin work tops also available. For more details see page 43
Material Used	Completely made of 0.8 to 1.2 mm Galvanised Iron (G.I) sheets. As galvanisation is 5 times more corrosion resistant than other steel sheets.
Under Bench Module	Completely made of GI sheets. Shutters and drawers in the front are of sandwich construction. Sound reducing polymer bumpers are provided to minimize banging noise while closing the shutters and drawers. The shutters are mounted to the modules by hinges which are openable upto 95 degree. Lockable roller bearings are provided to avoid accidental fall of drawers. The telescopic drawer slides are very sturdy and can hold load up to 35kg. All modules have lock and dual key arrangement.
Frame Construction	CR Square pipe is used for main frame structure and bottom support. Welded and finished with highly chemical resistant epoxy powder coating.
Knee Space Area	Openable back cover panel. Instrumentation and sitting area knee space will be 400 to 900 mm.
Sink & Tap	Polypropylene / Epoxy/ SS / porcelain sink with outlet nipple and three way / single way goose neck tap will be provided.
Reagent Rack	Two tier Reagent Rack will be made of 1mm thick G I Sheet and completely finished with epoxy powder coating. Top and Bottom rack 300 mm clear space and outer 380mm. Overall height 600 mm. Can be customised.
Switches & Sockets	Branded electrical socket with indicator switch 6/16 amps will be provided.
Hardware Fittings	<p>A) Handle : M.S. Powder Coating with structure / matt / Semi glossy smooth finish.</p> <p>B) Screw : All G.I. Visible screws.</p> <p>C) Lock : Godrej / Ebco branded lock with two keys.</p> <p>D) Drawer Slide : Precision telescopic slides of Ebco or equivalent.</p> <p>E) Hinges: Hettich powder coated hinges.</p>

options menu

Powder Coating	Complete module & frame work are finished with corrosion resistant Epoxy based / Polyester powder coating with 60 ±10 microns thickness.
Key Board Tray	Smooth quiet movement with telescopic slides. Unique arched hand rest to prevent fatigue while working. Locks at extended positions. Maximum load 12 kgs.
CPU Trolley	This saves valuable desk top space. Soft, vibration reduction pads provided. Width adjustment of 95mm provided.
Chemical Storage Cabinet	Storage Chamber will have 4 horizontal partition with 4 shutters. The Shutter will be provided with aesthetic powder coated handles with branded locking arrangements. Additional PP or FRP lining can be given (optional) as an extra protection against chemical spillage. Exhaust system also can be fixed to remove chemical vapour formation inside the cabinet.
Wall Storage Cupboards	One or two horizontal partition will be provided. The glass shutters will be provided with lockable doors and aesthetic powder coated handles with branded locking arrangements.

island / centre furniture



island / centre furniture

Laboratory Centre Table that are performance based and have high strength.
Our entire range is abrasion resistant in nature and is offered with standard configurations.

Features:

High in demand
Superior quality
Reasonable price

Accessories to add value to the table:

Telescopic rail for drawers
PP Sink with swan neck taps
Imported CED coated concealed Hinges
SS curved handle
Godrej or equivalent cam locks

A flourishing enterprise in this domain, engaged in presenting a wide range of Laboratory Tables. These tables are manufactured with the aid of latest manufacturing techniques by utilizing high grade raw materials adhering to industry standards. Our provided tables are used in laboratories for heating, mixing, and holding liquid or solid corrosive chemicals. Clients can avail these tables in numerous specifications as per their application demands at pocket friendly prices.

Features:

Flawless surface finish and uniform thickness
Ensure dependable potency and chemical compatibility
Delivers easy and quick installation owing to accurate dimensions
Crack resistance and provide shield against leaks

wall side furniture



wall side furniture

Working Table and Instrument Table:

we are affianced in offering Laboratory Working Benches. The offered benches are mainly assembled in for laboratory and research centres and systems. Our offered benches are highly demanded in laboratories, hospitals, and research institutions. Additional, the offered benches are manufactured by making use of premium quality raw materials and modern machinery by our experts. We offer these benches in several sizes and specifications in order to meet changing needs of our clients.

We are remarkable entity, engaged in offering superior quality Laboratory Instrument Table. Offered instrument tables are available in various specifications as per the needs of our customers. Our professionals manufactured these instrument tables by using quality approved material and latest techniques. These instrument tables are well known by clients for best usage.

Working Bench

We are known for providing world-class Laboratory working Bench, which is available in a wide array consisting of different designs and dimensions. Our Laboratory Benches are made as per the scientific specifications and are ergonomically designed to give a comfortable working space.

Quality:

Black Granite
Epoxy polyester
Pure Polyester powder coating
Pure Epoxy powder coating
on request.

Demanded by:

Pharmaceutical laboratories
Biotech laboratories
Educational institutes
Chemical industry
Paint industry
Oil industry
Research centers

Known for:

Contemporary designing
Sturdy construction
Scratch and bump resistance
Chemical resistance

fume hood and extractors



fume hood and extractors

Fume Hood that is widely used for the removal of gas, vapors and chemical mist. We offer these in order to meet the emission standards for safety to health and environment.

Features:

- Conventional Constant Volume
- Operate on constant volume principle
- Majority air enters through the opening of sash
- Exhaust volume remains constant
- Constructed with utmost precision
- Apt for general low hazard applications
- Low-pressure drop
- Highly efficient
- Maintenance free
- Noiseless operation
- Minimum energy requirement

vibration free tables



vibration free tables

We are recognized in the market as a preeminent Anti Vibration Table Manufacturer and Supplier from India. We are offering a high quality range of Anti Vibration Tables, which is manufactured as per scientific shock-proof area for accurate measurement for e.g., Galvanometer, various Sensitive Electronic Balances/ Instruments, as they support no vibration. We use prefabricated inner side in these tables and these are heavy weighed. The floor contact surfaces of the side rod of the table are fitted with special Anti-Vibration Rubber Pads.

Features:

- Contemporary design
- Perfect
- Robust construction
- Durable
- Wear and tear resistant
- Chemical resistant
- Reasonably priced

Demanded by:

- Chemical industry
- Research centers
- Pharmaceutical laboratories
- Biotech laboratories
- Educational institutes
- Paint industry
- Oil industry etc.

storage cupboards



storage cupboards

We use high grade sheet material and industry standard thickness to manufacture sample storage cabinet. Made from high quality material, these cabinets are resist against corrosion, scratch and vapors of various chemicals. These are provided with racks and exhaust port on top, which allows number of cabinets connected to common blower in cluster. These chemical storage cabinets are used to store chemical bottles, glassware, sample chemical units and other items in bulk.

Features:

- Various racks and shelves
- Easy to maintain
- Tough construction
- Perfect finishing
- Economical

Demanded by:

- Educational institutes
- Research centers
- Pharmaceutical laboratories
- Biotech laboratories
- Chemical industry
- Paint industry
- Pharma industry

General purpose safety cabinets designed for maximum strength and durability. Ideal to store frequently used supplies and chemicals in your academic lab that need to be secured.

We use high grade sheet material and industry standard thickness to manufacture sample storage cabinet. Made from high quality material, these cabinets are resist against corrosion, scratch and vapors of various chemicals. These are provided with racks and exhaust port on top, which allows number of cabinets connected to common blower in cluster. These chemical storage cabinets are used to store chemical bottles, glassware, sample chemical units and other items in bulk.

storage cupboards



storage cupboards

We Designed to store all the laboratory equipment and other articles like heavy chemical jars, our Industrial Slotted Angle Rack has neat compartments for proper organization. We are recognized in the market as a prominent Slotted Angle Rack Manufacturer and Supplier from India for the qualitative range that we present in this Laboratory Furniture.

Attributes:

- Neat and compact design.
- Perfect finishing.
- Number of shelves.
- Strong construction.
- Resistant to tarnishing.

Ideal for

- Laboratories.
- Sample rooms.
- Chemical storage rooms.

We use high grade sheet material and industry standard thickness to manufacture An exclusive range of Storage Locker is made available by us in a variety of designs. We manufacture Storage Lockers using premium quality raw materials that give it superior strength. Designed by experts, the qualitative construction of the Storage Locker has made us carve a niche among the major Manufacturers and Suppliers from India.

Attributes:

- Adjustable shelves.
- Strong locking system
- Available in various sizes.
- Robust construction.
- Durable.
- Easy to maintain and use.

Ideal for

- Chemical industry
- Research centers
- Pharmaceutical laboratories
- Biotech laboratories
- Educational institutes

storage cupboards



storage cupboards

We use high grade sheet material and industry standard thickness to manufacture Wall storage cupboards with doors and without doors. Made from high quality material, these cabinets are resist against corrosion.

These cabinets are used to store chemical bottles, glassware, sample chemical units and other items in bulk.

Attributes:

High strength Steel frame structure.
Clapboard - Tempered glass or steel sheet
Available in various sizes. Length can be customized
as per the customers request.
Robust construction.
Epoxy resin powder coated double layer steel shelves.
Acid and alkali resistant zinc cold rolled steel plate bracket.

Ideal for

Medical,
Educational,
Analytical & Research laboratories,
Chemical and
Pharmaceutical industries

work top options



Granite



Phenolic Resin



Stainless Steel



Wood



Epoxy Resin



Laminate

work top options

Granite: 18-20mm thick, G20 grade.

- The granite surfaces are epoxy coated to fill the natural stone pores. The epoxy coating is done using adsorption character of the stone surface, hence, it will not be visible and become more chemical resistant, Shiny, friction free.

Phenolic Resin Compact Composite: Chemical Resistant Solid Phenolic Compact composite is available with special performance properties. It is composed of multiple layers of kraft paper saturated with phenolic resin.

Biological, Chemical, Clinical, and Analytical Labs, experiments and tests performed in lab where results depend on non-contamination and require laboratory work surfaces that are exceptionally chemical resistant, impervious and hygienic

- Moderate Duty, High Bacterial Resistance, High Chemical Resistance,
- Moderate to High Corrosive Resistance, High Fungal Resistance,
- High Moisture Resistance, High Scratch Resistance,
- Continuous heat exposure up to 350 °F, Holds up to impact and stress fractures

Available colours: CARBON BLACK, GLACIER WHITE, STEEL GREY.

Epoxy Resin Matrix Composite:

- Chemical resistant and Flame retardant.
- Heavy Duty, Bacterial Resistance, Fungal Resistant, Scratch Resistant.
- Corrosive Resistant, Water and Moisture Resistant.
- Withholds continuous heat exposure up to 350 °F.

COUNTERTOP SELECTION AND COMPARISON CHART

	GRANITE	PHENOLIC	EPOXY	STAINLESS	WOOD	LAMINATE
Chemicals	★★★★★	★★★★★	★★★★★	★★★★	★★★	★★★
Abrasion	★★★★★	★★★★	★★★★	★★★★	★★★	★★★★
Heat	★★★★★	★★★★	★★★★★	★★★★★	★★★	★★★
Impact	★★★★★	★★★★	★★★★	★★★★★	★★★★	★★★★
Moisture	★★★★★	★★★★★	★★★★★	★★★★★	★★★	★★★
Bacteria	★★★★★	★★★★★	★★★★★	★★★★★	★★	★★

colour options

VIP Blue

Radium Green

Mangla Yellow

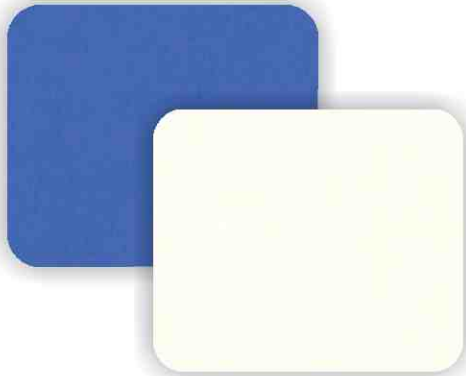

Half White

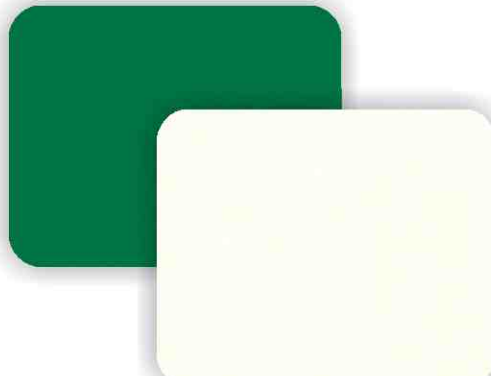

Half White

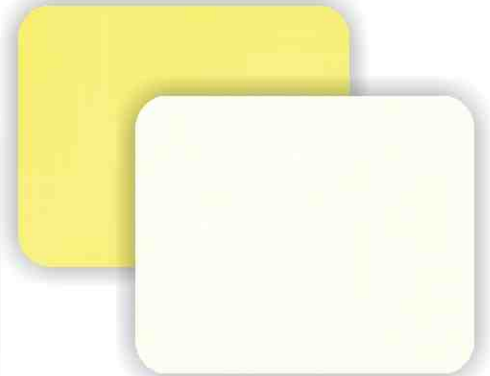

Half White

Anar Red

Sober Gray

Pleasant Orange

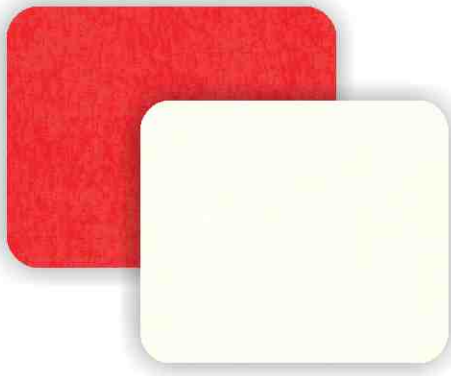

Half White

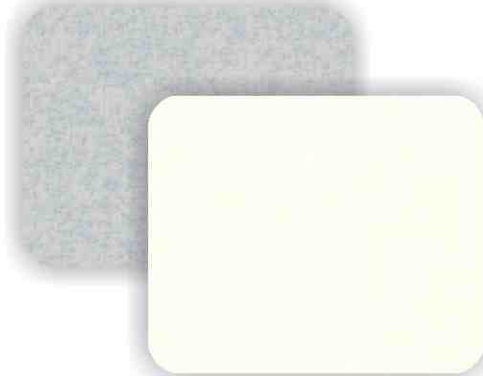

Half White



Half White

Important Note: The colours shown in the print may differ from the original colour.
We can send sample sheets to take the final decision.

sample plan diagram

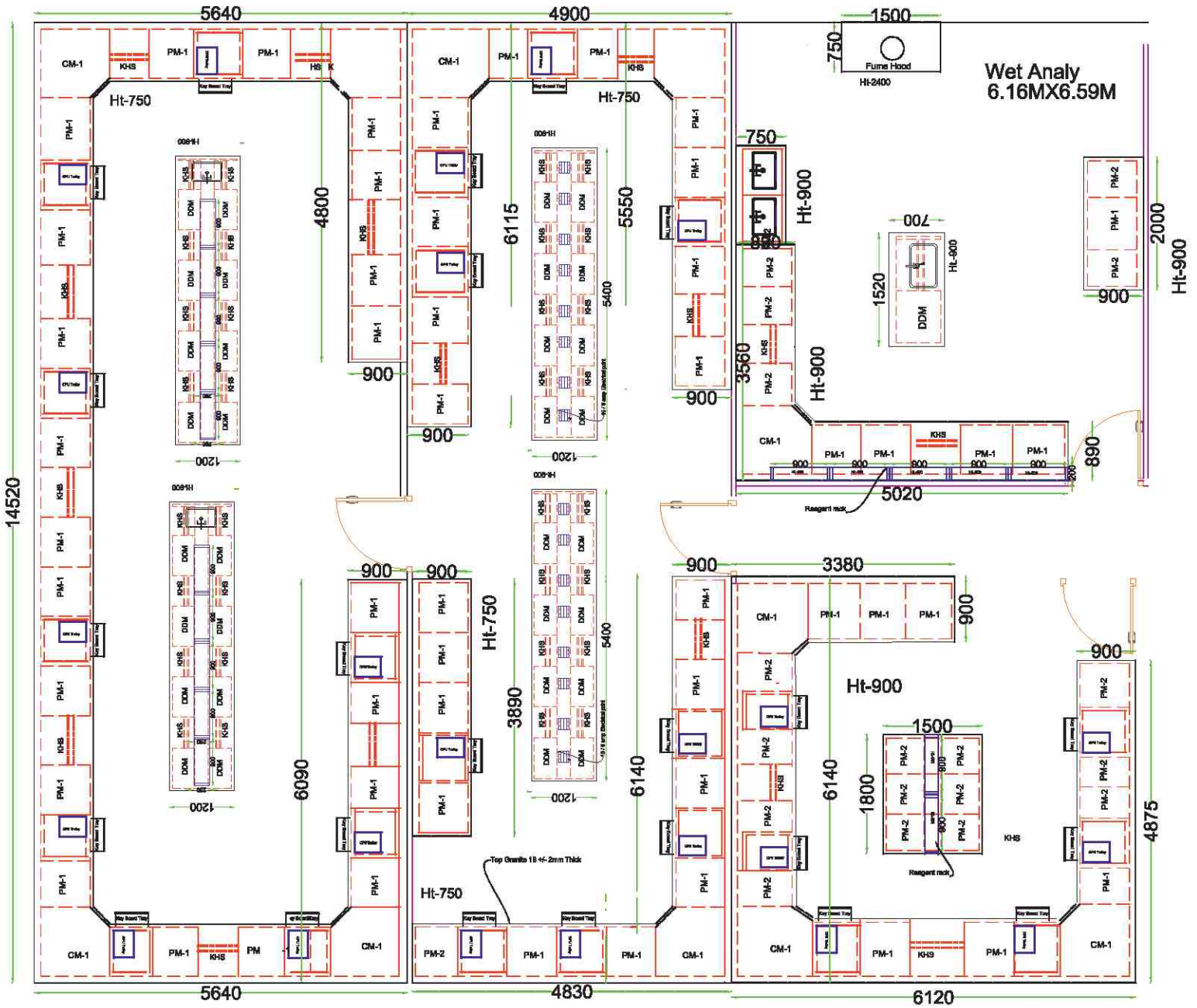

sample plan diagram

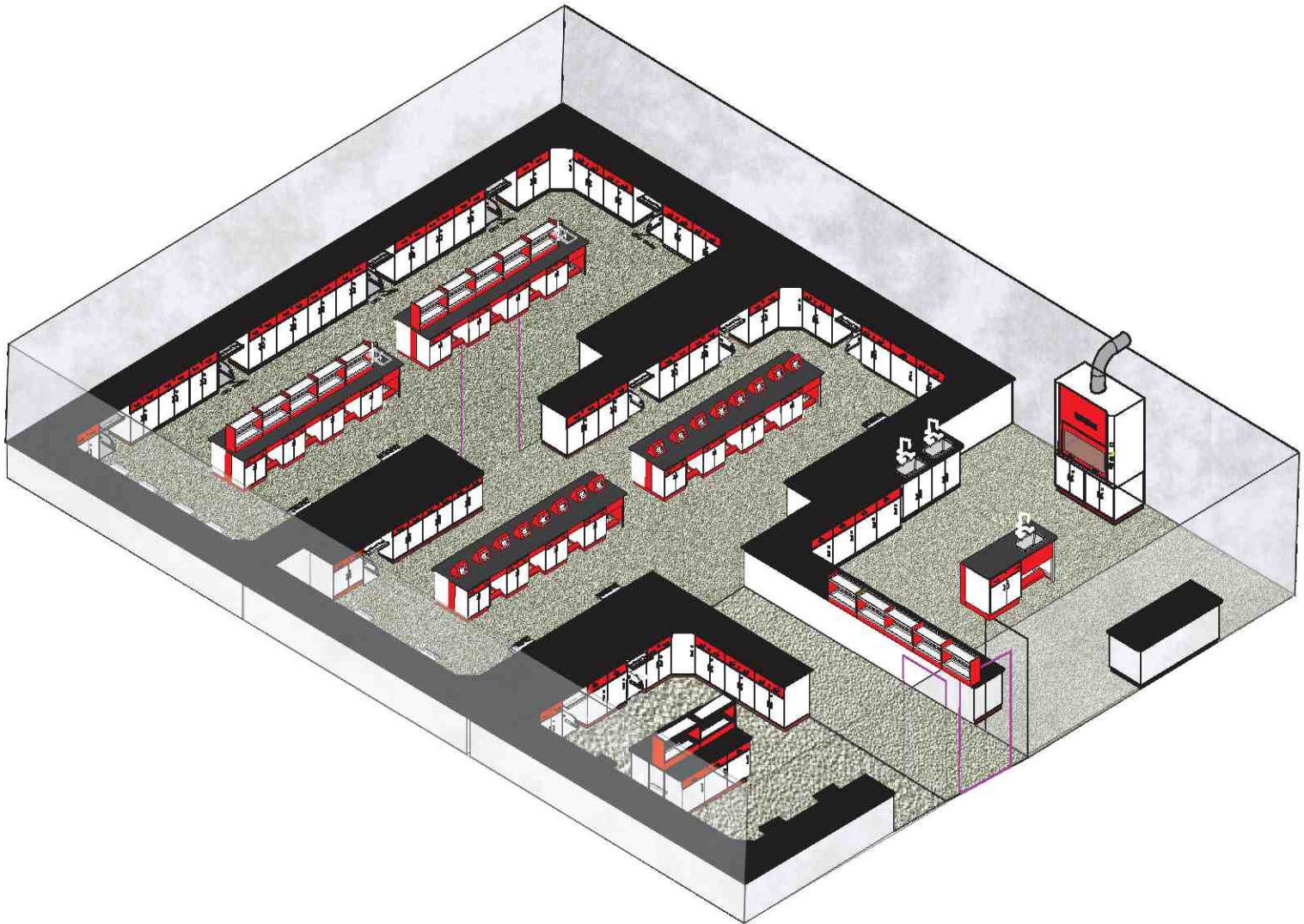

sample plan diagram

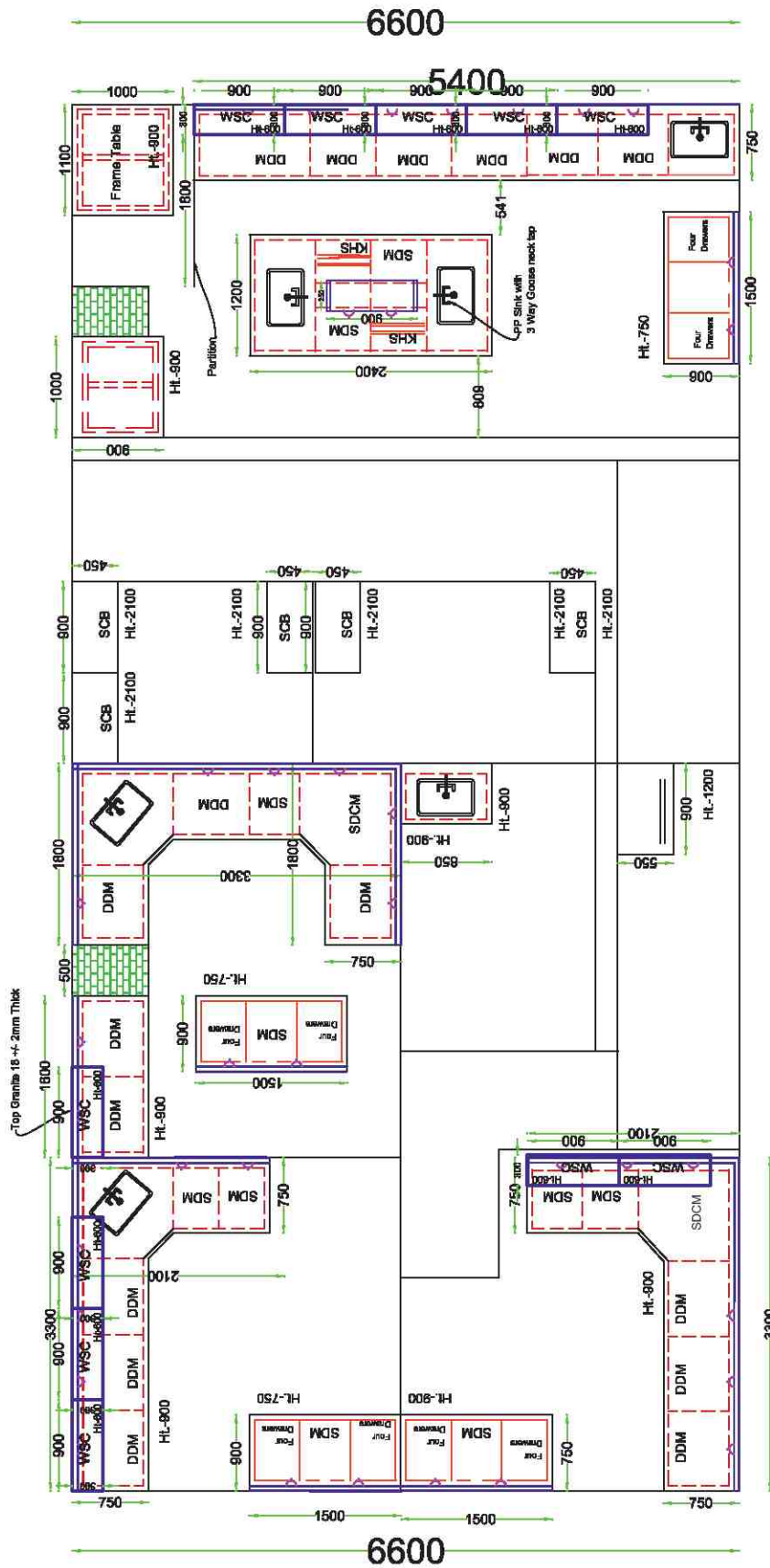

sample plan diagram

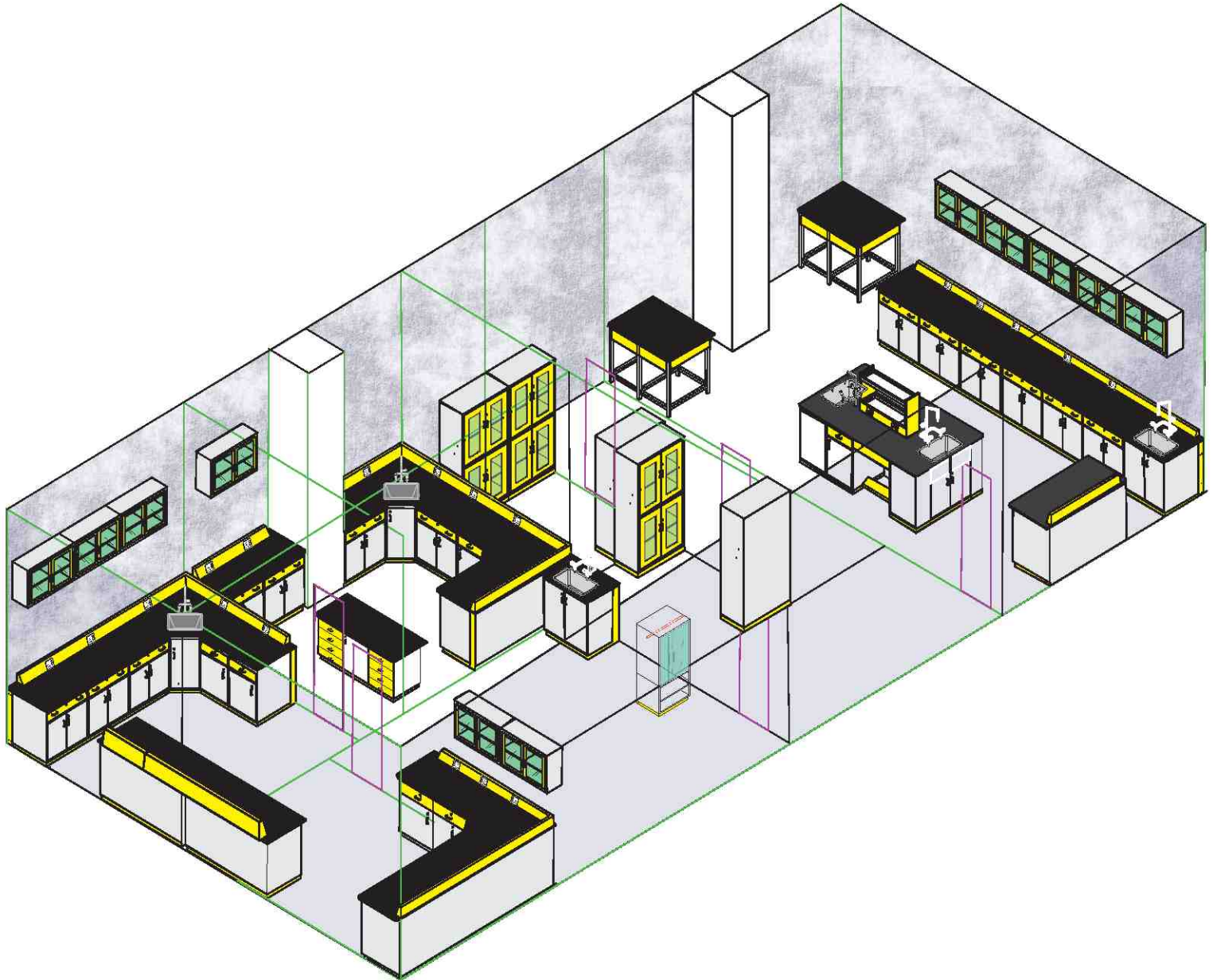

sample plan diagram

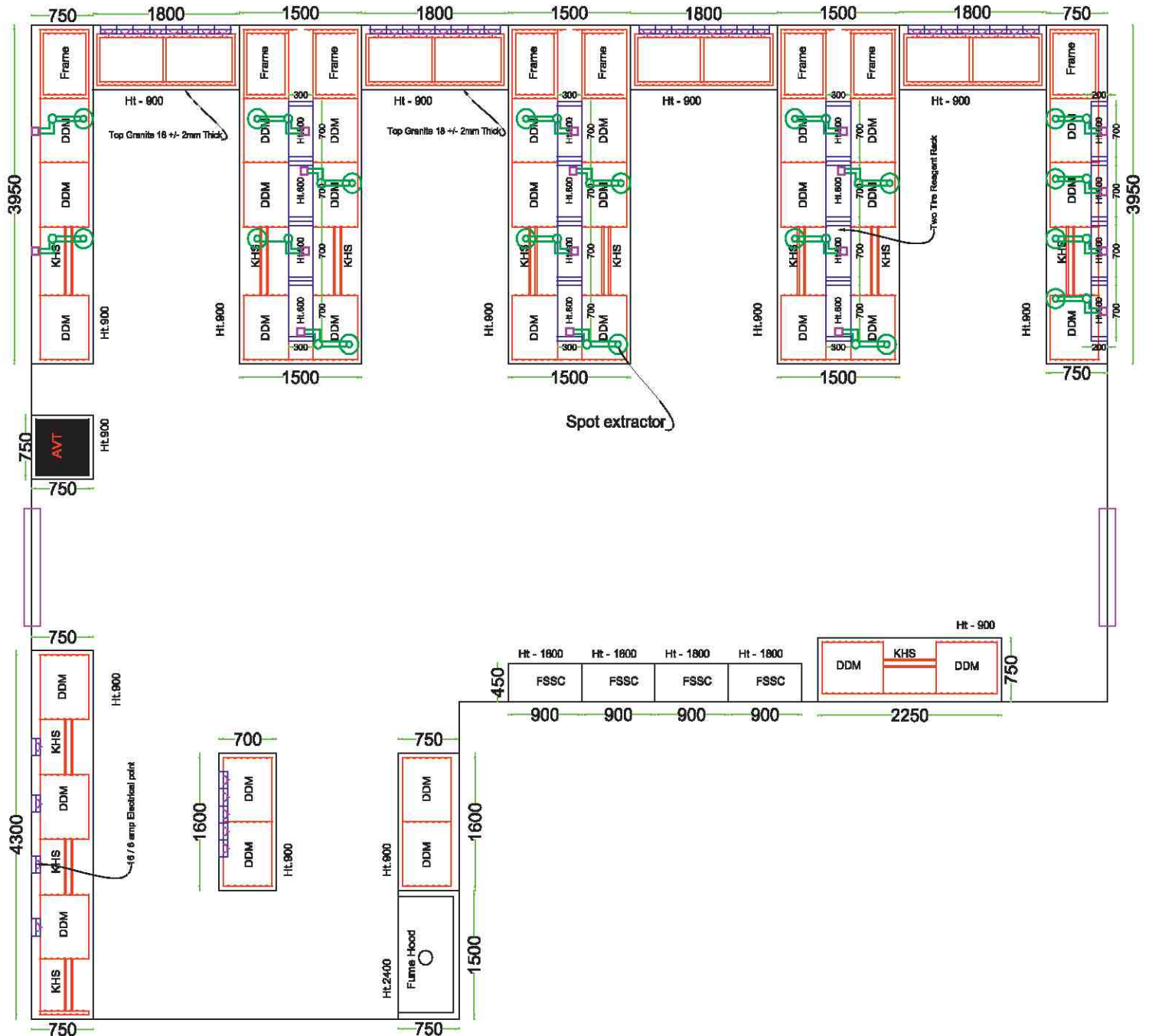

sample plan diagram



customer project details

Automobile

- Ashok Leyland India Pvt Ltd - Hosur
- Auto Pro Technologies - Bangalore
- Bosch Ltd., Bangalore (Aahaa Stores Pvt Ltd)
- Brakes India Ltd, Padi, Chennai
- Breaks India Pvt Ltd, Sholinghur
- GKN Sinter Metals Private Limited, Pune
- HSML Automotives Ltd, Chennai
- India Yamaha Motor Private Limited - Sriperumbudur
- Precision Products Marketing Pvt Ltd, Jawahar Nagar
- Promptekk Metal Alloys&Refining Corpn., Chennai
- Phorotech Surfin (India) Private Limited, Sriprumbudhur
- Real Talent Engineering Ltd, Sholingnalore
- Renault Nissan India Pvt. Ltd, Mahendhra City
- Visteon Automotive Systems India Pvt Ltd
- Woosu Automotive India Pvt Ltd, (Thiruvallur)

Animal Feed

- Grobest Feeds Corporation (India) Ltd, Chennai

Cement Mfg.

- Dalmia Cement (Bharat) Ltd, Chennai
- JSW Cement Ltd, Bangalore
- JSW Cement Ltd, Bellory

Chemical

- Balmer Lawrie & Co. Ltd, Chennai
- Chemlife Innovation Pvt. Ltd, Bangalore
- Glinkem, Ashok Nagar, Chennai
- IEC Fabchem Limited, Gummidipoondi
- Nerokem Speciality Products, Chennai
- Saint - Gobain India Pvt Ltd - Tiruvallur
- Sukra Syntheticks, Hosur, Bangalore
- Trimex Sands Pvt Ltd, Srikakulam

Electronics

- Apex Coco and Energy Limited, Tirupur
- BBL Daido Pvt Ltd, Kelampakkam
- Flextronics Tech (I) Pvt. Ltd, Chennai
- Habasit lakoka Pvt Ltd, Coimbatore
- Saratha Electroplaters, Chennai
- Shandong Tiejun Electric Power Engg Co.Ltd, Cuddalore
- Spincotech Pvt. Ltd, Alathur
- Spinco Biotech Pvt. Ltd,- Bangalore

Engineering

- Sankar Sealings, Chennai
- Spinks Softech Pvt Ltd, Sriprumbudur

Food & Oil

- Adamjee Lukmanjee (Pvt) Ltd, Sri Lanka
- BTS Roller Flour Mill Pvt Ltd, Bangalore
- Cavinkare Pvt Ltd, Chennai
- Doehler India Pvt Ltd, Pune
- Hima Aqua Minerals, Gummidipoondi
- Integrated Food park - Tumkur
- KTV Food Products (India) Pvt Ltd, Gummidipoondi
- KTV Food Products (India) Pvt Ltd, Tuticorin
- KTV Health Food Pvt Ltd, Kodungaiyur
- Perfetti Van Melle India Pvt Ltd, Guduvancherry
- SGR 777 Foods, Chennai
- Super Tasty Bakery Foods India Pvt. Ltd, Bangalore
- Spices Board - Tuticorin
- Vijay home Foods Pvt Ltd - Trichy
- The Akshaya Patra Foundation, Bangalore
- The Nilgiri Dairy Farm Private Limited, Bangalore
- Zwilling Kitchen India Pvt Ltd, Cheyyur
- Freshalicious Super Bazaar Pvt Ltd, Bangalore
- Petunt Food Processors Pvt Ltd, Bangalore
- IG Berries Pvt Ltd, Chhindwara - Madhya Pradesh
- INDO MIM - Bangalore
- ITC Limited, Chennai

Flavours & Fragrance

- Jasmine Concrete Exports Pvt Ltd, Chennai
- Jasmine Concrete Exports Pvt Ltd, Didugal
- Shirdi Sai Nutraceuticals Pvt.Ltd, Bangalore

Research

- CDD (Consortium for Dewats Dissemination) Society, Bangalore
- Clinbiocare technology, Chennai
- Graphene Nano Innovations Pvt Ltd, Bangalore
- ICTS, Bangalore
- SCI FI Biologicals, Bangalore

Paint

- Noroo BEE Chemical India Pvt Ltd - Sriperambudur
- Shalimar paints Ltd - Gummidipoondi
- Sheenlac paints corp, Chennai

customer project details

Hospital & Health Care

- ❑ Bangalore Baptist Hospital, Bangalore
- ❑ Biomet Visa (India) Private Limited (STEMZ), Chennai
- ❑ Biomet Visa (India) Private Limited (STEMZ), Delhi
- ❑ Biomet Visa (India) Private Limited (STEMZ), Mumbai
- ❑ Biomet Visa (India) Private Limited (STEMZ), Kolkata
- ❑ Biomet Visa (India) Private Limited (STEMZ), Hyderabad
- ❑ Biomet Visa (India) Private Limited (STEMZ), Cochin
- ❑ Biomet Visa (India) Private Limited (STEMZ), Lucknow
- ❑ Biomet Visa (India) Private Limited (STEMZ), Chennai
- ❑ Fetomed Laboratories Pvt. Ltd (Life Cell), Chennai
- ❑ Kannanan Diagnostics, Mysore
- ❑ Harish Diagnostics, Tumkur
- ❑ Meenakshi Hospital, Thanjavur
- ❑ St. John's Medical College, Bangalore
- ❑ DR.SRB Prasad., MSD, Ambattur, Chennai

Pharma

- ❑ Claris Injectable Limited, Ahamedabad
- ❑ Central Drugs & Pharmaceuticals, Chennai
- ❑ Caplin Point Laboratories Pvt Ltd, Gummidipoondi
- ❑ Life Cell International Pvt Ltd, Vandalur-Keelakottaiyur
- ❑ Fetomed Laboratories Pvt Ltd (Life Cell), Chennai
- ❑ Randox Laboratory, Bangalore
- ❑ Reginix Drugs Pvt. Ltd, Chennai
- ❑ Richcore Life Sciences Pvt. Ltd, Bangalore
- ❑ Sangene Biotech, Bangalore
- ❑ Synkromax Biotech Private Limited, Chennai
- ❑ Shasun Pharmaceuticals Limited , Pondicherry
- ❑ Shasun Pharmaceuticals Limited, Cuddalore
- ❑ Lakhi Parmatma Charitable Trust, Kolkata
- ❑ Pharma Genica Health Care, Bangalore
- ❑ Steril-Gene Life Sciences P Ltd, Pondicherry
- ❑ TIL Healthcare Pvt Ltd - Chittoor
- ❑ Indra Chemical Manufacturing Pvt Ltd (IRIS), Chennai
- ❑ Vascular Concepts, Bangalore

Plastic

- ❑ Wim Plast Ltd . Chennai

Textiles Testing

- ❑ Avgol India Pvt Ltd - Bhopal
- ❑ Bureau Veritas, Chennai
- ❑ Bureau Veritas, Thirupour
- ❑ Log 9 Materials Scientific Pvt, Bangalore
- ❑ Silk Board (Lab Supplies), Bangalore

Commercial Testing

- ❑ Alex Stewart International (India) Pvt Ltd - Odisha
- ❑ Chennai Calibration Centre, Chennai
- ❑ Emerald Testing (India) Pvt Ltd, Coimbatore
- ❑ Enviro India Pvt Ltd, Thiruvallur
- ❑ MS Gold Hallmarking Centre, Chennai
- ❑ Kesar Assaying & Hallmarking Centre, Chennai
- ❑ Sree Vishnu Assaying & Hallmarking Centre, Chennai

Government

- ❑ Indian Oil Corporation Ltd, Vijayawada
- ❑ Kudankulam Nuclear Power Project, Kudankulam
- ❑ Madras Atomic Power Station, Kallapakkam
- ❑ Madras Regional purchase Unit (IGCAR), kalpakkam
- ❑ MSME - Centr for Footware Technology, Chennai
- ❑ National Aerospace Laboratories, Bangalore
- ❑ Soil Testing Laboratory - Tirunelveli
- ❑ Vikram Sarabhai Space Centre, Trivandrum
- ❑ CFTRI, Mysore
- ❑ Bharat Petroleum Corporation Limited (BPCL), Kochi

basic lab safety rules

- ❑ Know locations of laboratory safety showers, eye wash stations, and fire extinguishers.
- ❑ Know emergency exit routes.
- ❑ Avoid skin and eye contact with all chemicals.
- ❑ Minimize all chemical exposures.
- ❑ Assume that all chemicals of unknown toxicity are highly toxic.
- ❑ Avoid distracting or startling persons working in the laboratory.
- ❑ Combine reagents in their appropriate order, such as adding acid to water.
- ❑ Do not taste or intentionally sniff chemicals.
- ❑ Never consume and/or store food or beverages or apply cosmetics in areas where hazardous chemicals are used or stored.
- ❑ Wash exposed areas of the skin prior to leaving the laboratory.
- ❑ Long hair and loose clothing must be pulled back and secured from entanglement or potential capture.
- ❑ Laboratory safety glasses or goggles should be worn in any area where chemicals are used or stored.
- ❑ Avoid wearing jewellery in the lab as this can pose multiple safety hazards.
- ❑ Clothing made of synthetic fibres should not be worn while working with flammable liquids.



Dress code safety



Personal protection safety



Chemical safety



Electrical safety

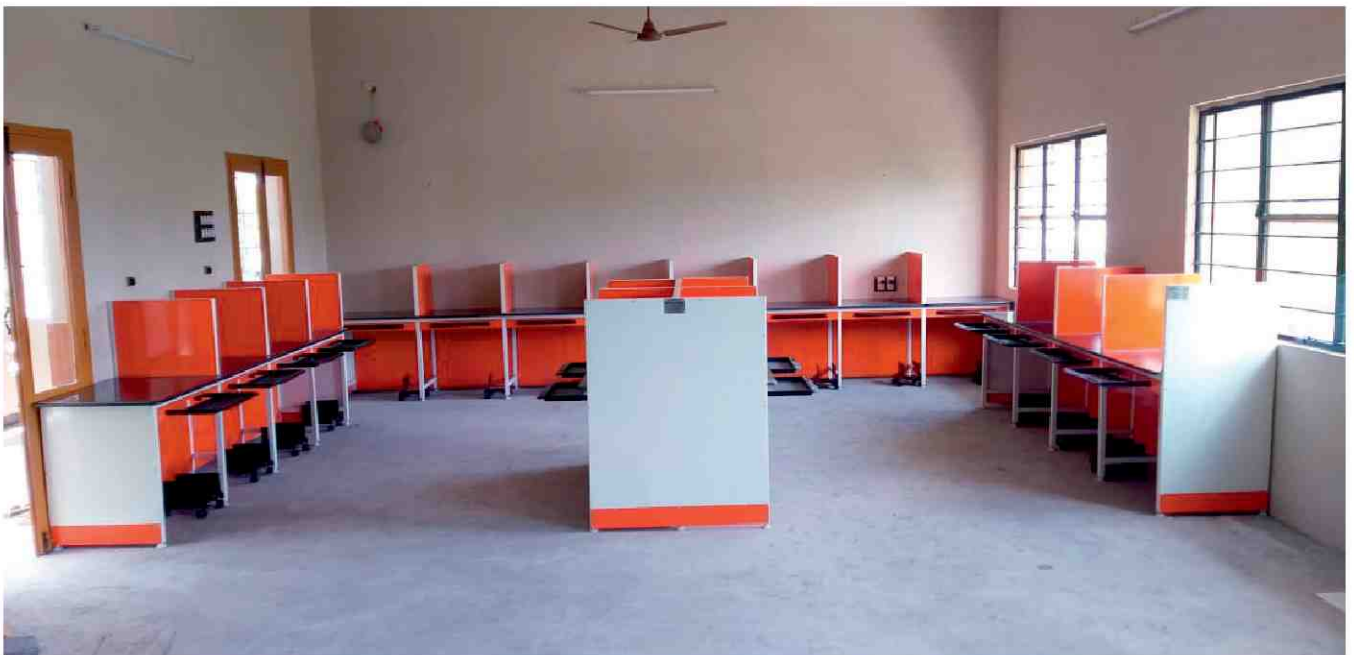

METROLABS

Lab Furniture | Fume Hood | Anti-Vibration Table | Storage Cupboards

no.ts-04, sidco, micro industrial estate, thirumudivakkam, chennai - 600 044

m:+91-9840931231 / 9791033312

metrolabs1@gmail.com, www.metrolabs.biz