

We *design,*
manufacture,
and *install*
lab furniture.

METROLABS

Lab Furniture | Fume Hood | Laminar Airflow | Storage Cupboard

We are there when you need us !

INDUSTRIAL & PHARMACEUTICALS LAB FURNITURE CATALOGUE

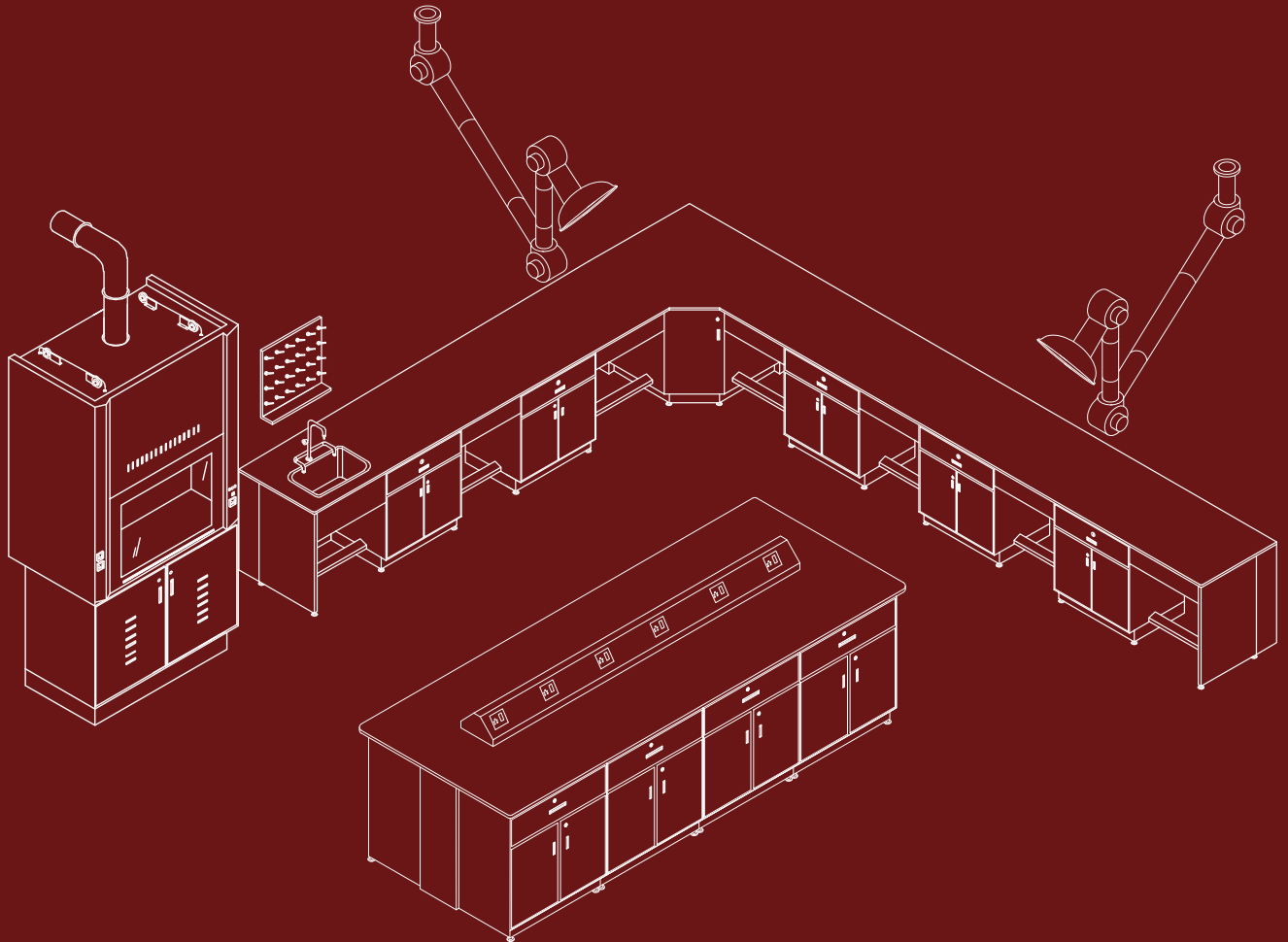

www.metrolabs.biz

QUALITY, DURABILITY AND VALUE

We recommend our metal case furniture for all your labs. When you choose to buy our high quality lab tables, you are assured that they are made using top-quality material.

The materials that we use are of top most quality, will last long and will require very low maintenance. Easy to clean, most commercial cleaners can be used on the metal.

Quality is assured and repairs will be taken care of with no hassle at the earliest possible time.

We are there when you need us!

In labs where explosion or fire are a big risk, metal lab furniture is ideal, due to its high resistance to heat. Generally, lab storage cabinets built to code are able to withstand a high degree of heat for a longer period of time, unlike wood.

Lab layout and use might need changes over time. Metal furniture, such as casework and tables, can be fixed or modular. The modular tables can be re-located or re-arranged very conveniently.

METROLABS
Lab Furniture | Fume Hood | Laminar Airflow | Storage Cupboard
We are there when you need us !



www.metrolabs.biz

Dear Sir / Madam,

Greetings from Metrolabs !

We are very honoured that you are going through our catalogue of Industrial and Pharmaceuticals Lab Furniture.

We hope this will help you to build the dream lab for your students.

We are going to guide you here, step by step, with the complete method of setting up a new science lab for schools, colleges and Research Institutions.

We are there when you need us !

Our best wishes,
Team Metrolabs

METROLABS

Lab Furniture | Fume Hood | Laminar Airflow | Storage Cupboard

We are there when you need us !

FURNITURE FOR
THE LABS

PHARMA

BULK DRUG

FOOD

AUTOMOBILE

CHEMICALS

NUCLEAR POWER

PETROLEUM REFINERY

and Many more



metrolabs1@gmail.com

Choose your requirements

Here is a selection of documents to help you with your laboratory furniture planning. If you would like to discuss your enquiry further please call 98409 31231 and speak to our sales team or drop us an email.

Frequently Asked Questions

- How much does laboratory Furniture cost?
- Standard Lab Bench Dimensions

How Much Does A Laboratory Furniture Cost?

Looking for an answer. Maybe we can help but the honest answer is....it depends. If you'd like a very quick price per square feet of lab furniture, drop us an email with the details. Information we require to laboratory furniture plan and provide a quotation:

- Your Contact details
- Delivery address
- Provide the following details of laboratory furniture options:
 - Required Table Size and Quantity
 - Required Facilities on the table like Sink, Electrical Points, Eye Wash, Pegboards Keyboard tray, CPU Trolley, etc
 - Table Top – we have options of Granite, Phenolic Resin, Epoxy Composite, Plywood, SS, Ceramic, etc..

Free Design and Layout Service

We offer a free design and layout service, the start of your total laboratory solution. Use our 20+ years of experience to help build your new lab.

If you are interested in purchasing one-off items this is not a problem. Please visit our Lab Furniture Products page to view our standard range of items.

If you require references please contact or in the meanwhile check out our **Customer Reference** page to find some happy customers.

If you need some help putting together information for your enquiry please view and download the appropriate document in <https://www.metrolabs.biz/laboratory-furniture-faq/> Fill in as much information as you can then return via email (metrolabs1@gmail.com) or WhatsApp us 98409 31231 or 97910 33315

Table Top

We offer black granite, Epoxy composite, Composite Phenolic resin, Quartz and many more.



Granite Phenolic Resin Epoxy Resin

Material Used

Completely made of 0.8 to 1.2 mm Galvanised Iron (GI) Sheets. Galvanised sheets are 5 times more corrosion resistant than other steel sheets.



Under Bench Module

Completely made of GI sheets. Shutters and drawers in the front are of sandwich construction. Sound attenuating polymer bumpers are provided to minimize the noise while closing the shutters and drawers. Lockable roller bearings are provided to avoid accidental fallout of drawers. The telescopic drawer slides are very sturdy and can hold loads up to 26kg (as Uniformly Distributed Load). All modules have lock and dual key arrangement as default. That may also be customised.



Frame Construction

CR Square pipe is used for main frame structure and bottom support. Welded and finished with highly chemical resistant epoxy powder coating.



Knee Space Area

Instrumentation and sitting area knee space will be 400 to 750 mm. Completely made up of 1mm thick GI Sheet and finely finished with epoxy powder coating.



Sink and Tap

Polypropylene / Epoxy/ SS / Porcelain sink with outlet nipple, without drain hose. Three way / single way goose neck tap will be provided for each sink.



Reagent Rack

Two tier Reagent Rack is made up of 1mm thick GI Sheet and finely finished with epoxy powder coating. Top and Bottom racks have 324 mm clear space. Overall height 600 mm. Each rack has usable space of 600 x 220 mm and It can be customised.



Electrical switch box

Electrical socket with indicator switch of 6/16 amps is provided where ever required.



Fittings

- A) Handle : Aluminium Flush handle.
- B) Screws : All G.I. Visible screws.
- C) Lock : Cam lock with two keys.
- D) Drawer Slide : Precision telescopic sliders.
- E) Hinges: Crank / Butt hinges.



Powder Coating

Complete module and frame work are finished with corrosion resistant Epoxy based / Polyester powder coating with 60 ±10 microns thickness.



Key Board Tray

Smooth quiet movement with telescopic slides. Unique arched hand rest to prevent fatigue while working. Locks at extended positions. Maximum load 12 kgs.



CPU Trolley

This saves valuable desk top space. Soft, vibration reduction pads provided with an adjustment of 95mm.



Chemical Storage

Storage Chamber has horizontal partitions with required shutters. The shutter with air holes are provided with aesthetic powder coated handles and locking arrangements. Additional PP lining can be given as an extra protection against chemical spillage. Exhaust system also can be fixed to remove chemical vapour formation inside the cabinet.



Legends

DDM - Double Door Module; SDM - Single Door Module; CSDM - Corner Single Door Module; KHS - Knee Hole Space (Foot Rest)

LAB UNDER BENCH CABINET MODELS

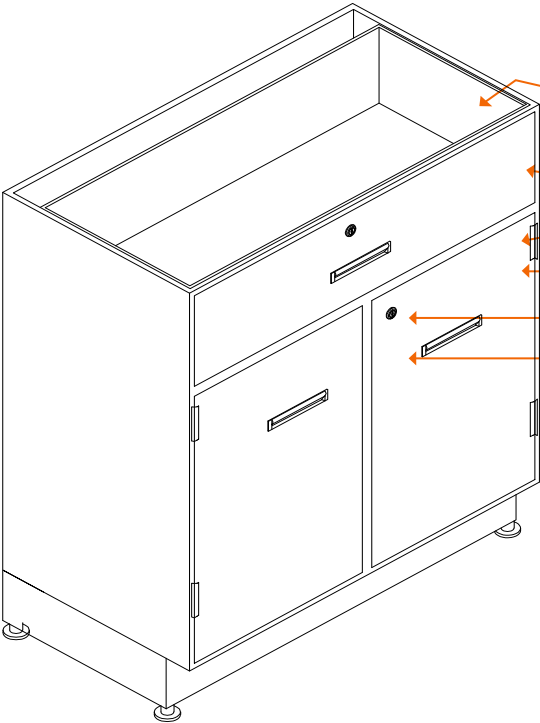

- Full extension, ball bearing, plated drawer slides
- Doors and drawer heads are "double pan" construction and sound deadened
- Adjustable doors with full access opening
- Branded Cam Lock- user frendly
- Full depth adjustable shelf Adjustable on 2" centers

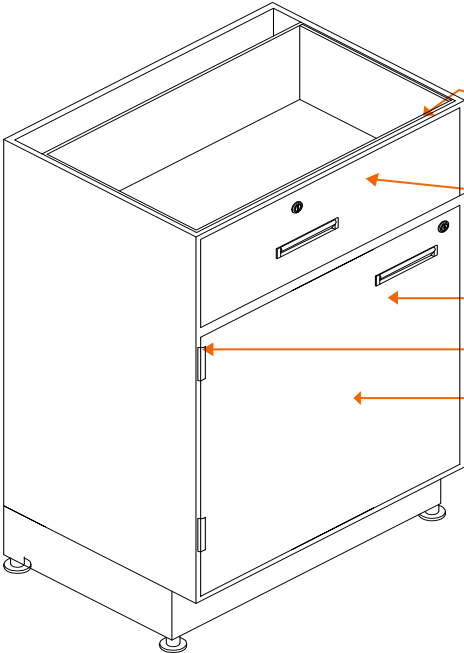

- Full extension, ball bearing, plated drawer slides
- Doors and drawer heads are "double pan" construction and sound deadened
- Adjustable doors with full access opening
- Branded Cam Lock- user frendly
- Full depth adjustable shelf Adjustable on 2" centers

Gauges of base cabinet components

Back Panels	1 mm thick.
Bottom Panels	1 mm thick.
Drawer/Door Outer Panel	1 mm thick.
Door Inner Panel	1 mm thick.
Drawer Bodies	1 mm thick.
Bottom	1 mm thick.
Shelves	1 mm thick.

All surfaces shall be painted or zinc plated. The paint is chemical and UV resistant baked on epoxy-hybrid powder. Specific test data is available upon request.

For complete specifications, request our full line of product specifications. Subject to change.

LAB UNDER BENCH CABINET MODELS

METROLABS

Lab Furniture | Fume Hood | Laminar Airflow | Storage Cupboard

We are there when you need us !

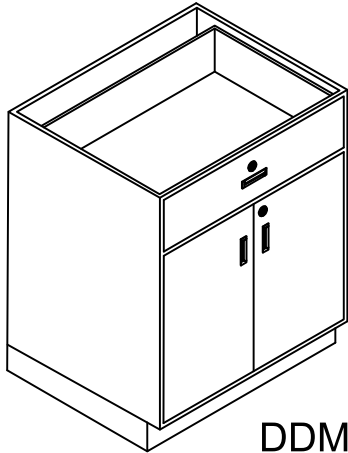

DDM

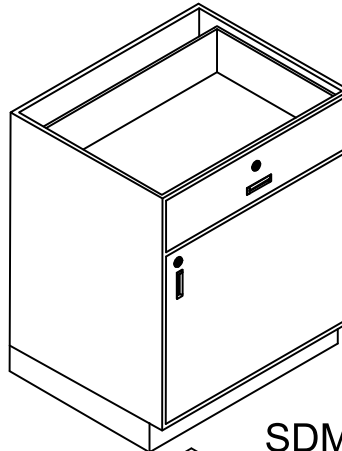

SDM

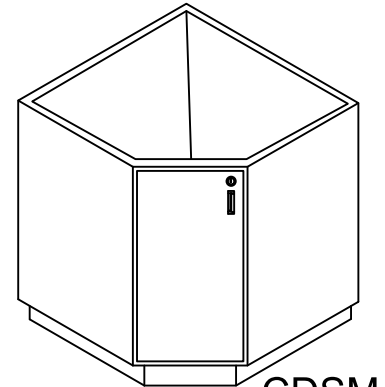

CDSM

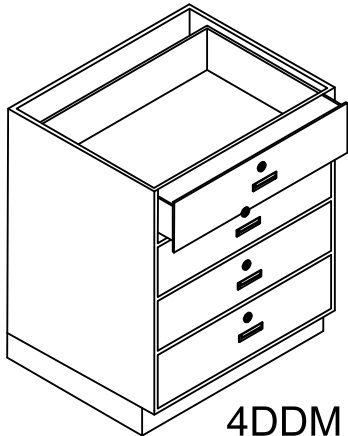

4DDM

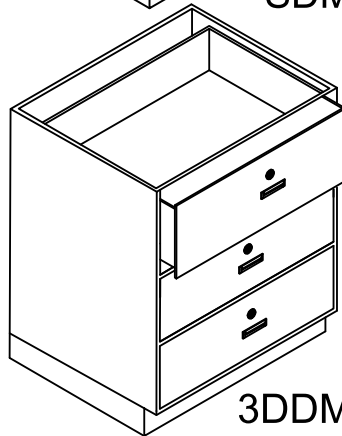

3DDM

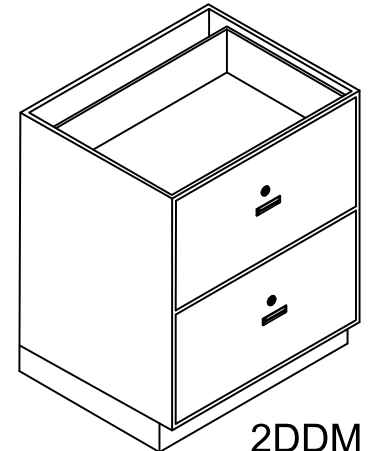

2DDM

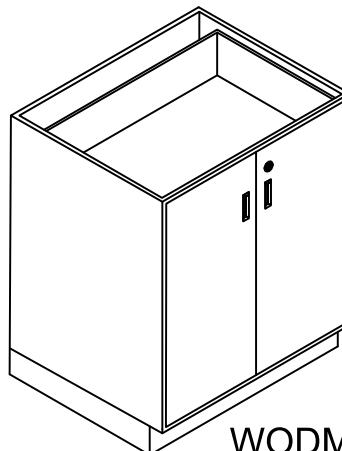

WODM

LABORATORY FUME HOODS

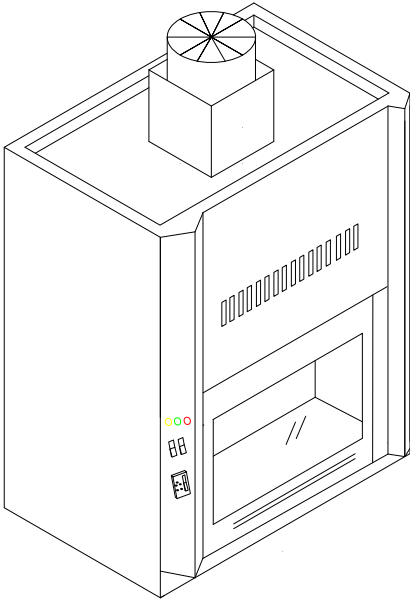
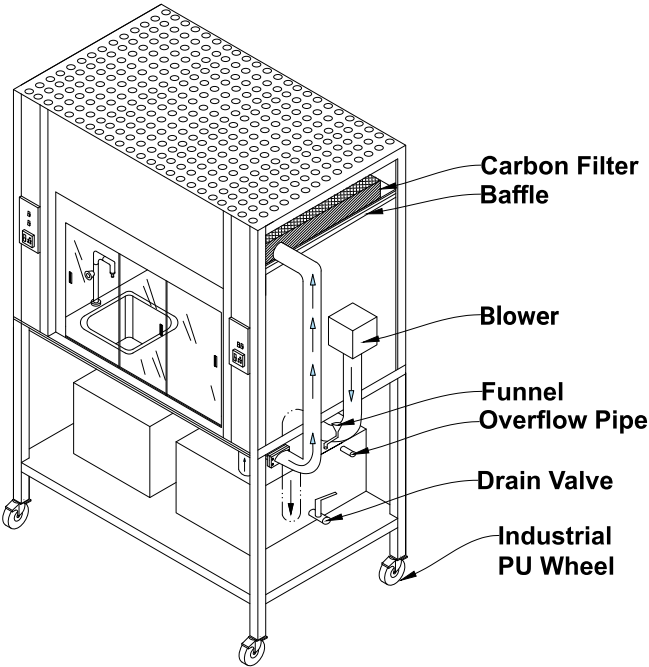
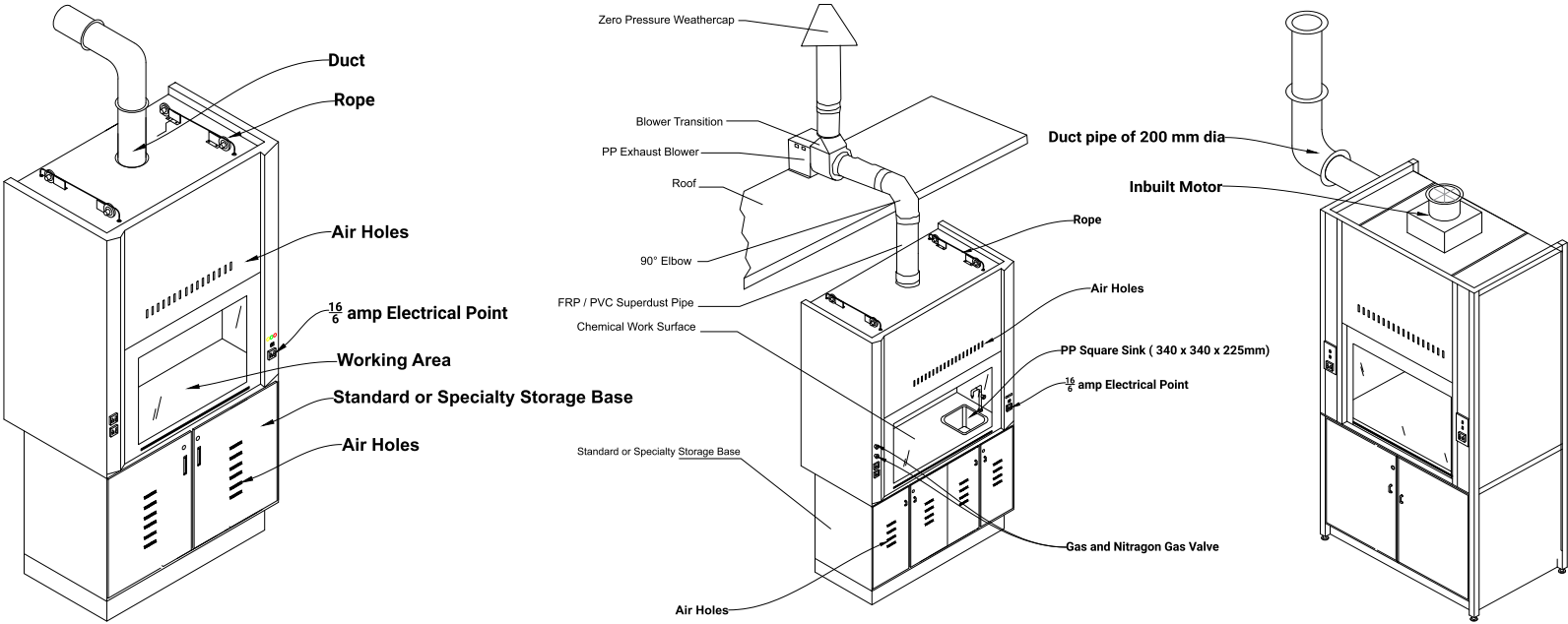

LAB CUPBOARD MODELS

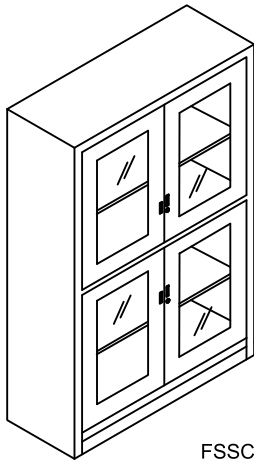

FSSC

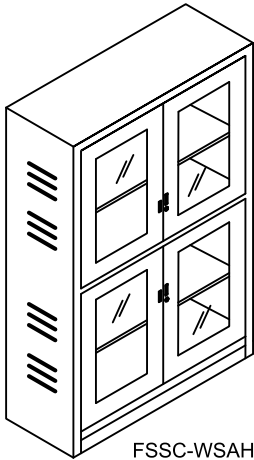

FSSC-WSAH

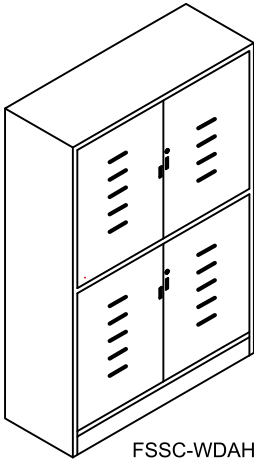

FSSC-WDAH

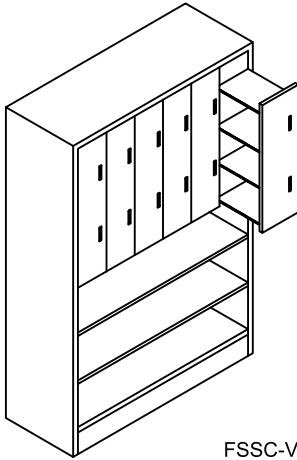

FSSC-V

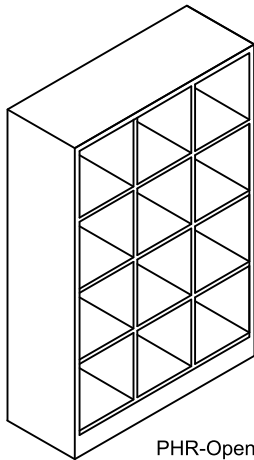

PHR-Open

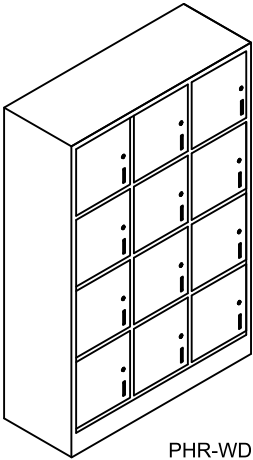

PHR-WD

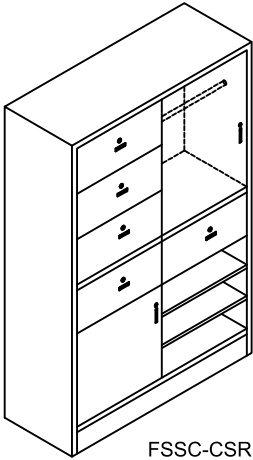

FSSC-CSR

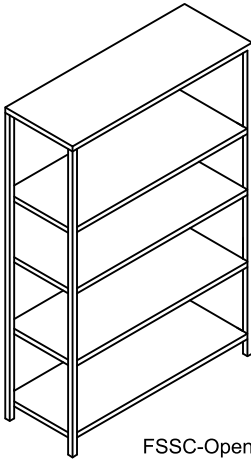

FSSC-Open

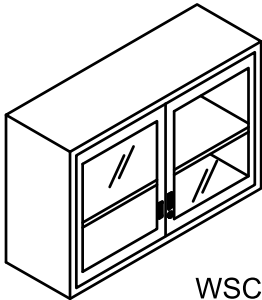

WSC

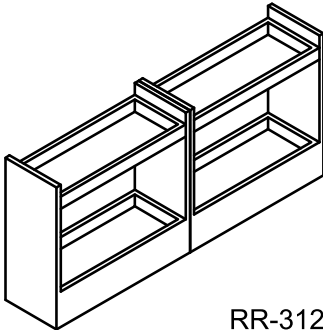

RR-312

ISLAND TABLE

We are there when you need us !

1800 x 1200 x 900 mm ht. (6 x 4 x 3 ft)
2 modules

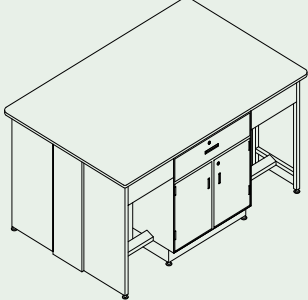

1800 x 1200 x 900 mm ht. (6 x 4 x 3 ft)
4 modules

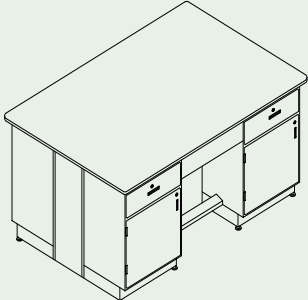

1850 x 1200 x 900 mm ht. (6 x 4 x 3 ft)
6 modules

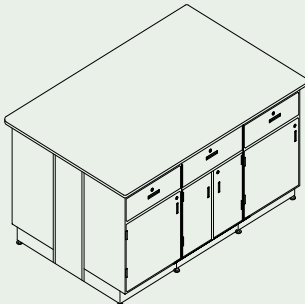

1850 x 1200 x 900 mm ht. (6 x 4 x 3 ft)

(A)

(B)

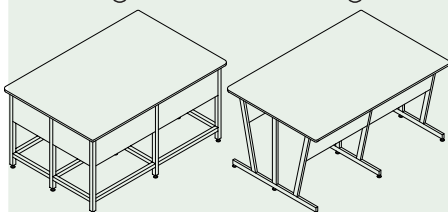

2100 x 1200 x 900 mm ht. (7 x 4 x 3 ft)
2 modules

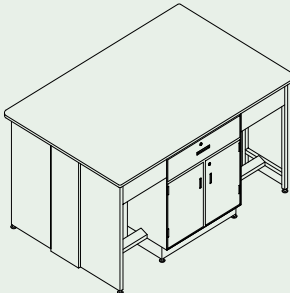

2100 x 1200 x 900 mm ht. (7 x 4 x 3 ft)
4 module

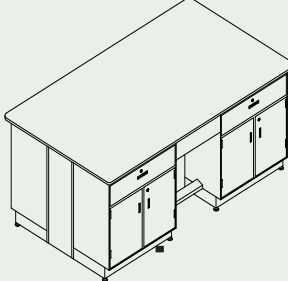

2100 x 1200 x 900 mm ht. (7 x 4 x 3 ft)
4 module

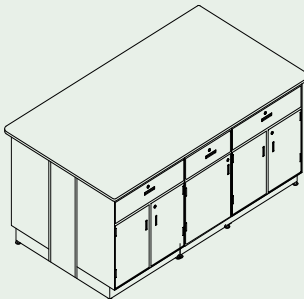

2100 x 1200 x 900 mm ht. (7 x 4 x 3 ft)

(A)

(B)

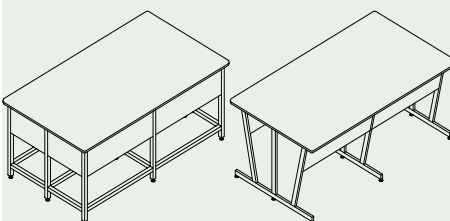

2400 x 1200 x 900 mm ht. (8 x 4 x 3 ft)
2 module

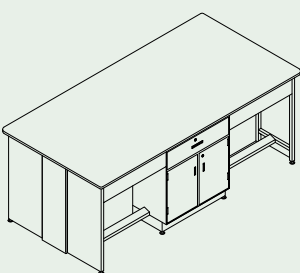

2400 x 1200 x 900 mm ht. (8 x 4 x 3 ft)
4 module

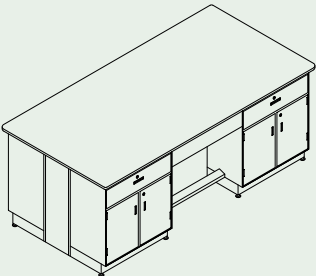

2350 x 1200 x 900 mm ht. (8 x 4 x 3 ft)
6 module

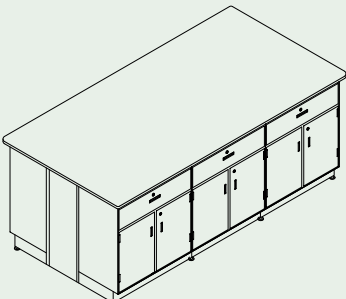

2400 x 1200 x 900 mm ht. (7 x 4 x 3 ft)

(A)

(B)

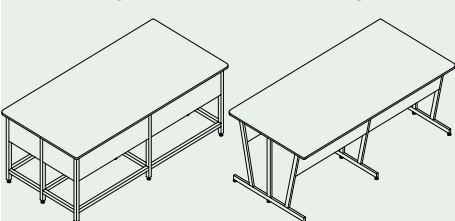

ISLAND TABLE

METROLABS

Lab Furniture | Fume Hood | Laminar Airflow | Storage Cupboard

We are there **when** you need us !

2400 x 1500 x 900 mm ht. (8 x 5 x 3 ft)
2 module

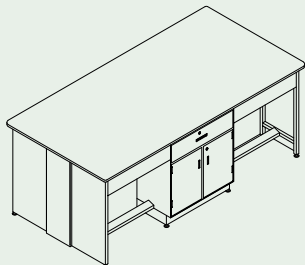

2400 x 1500 x 900 mm ht. (8 x 5 x 3 ft)
4 module

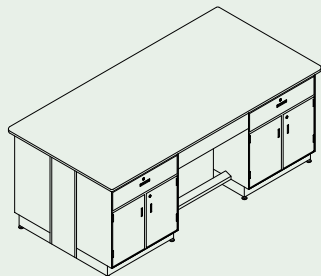

2350 x 1500 x 900 mm ht. (8 x 5 x 3 ft)
6 module

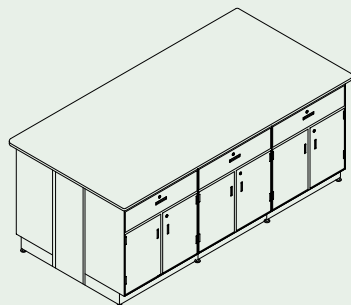

2400 x 1500 x 900 mm ht. (7x5x3feet)

(A)

(B)

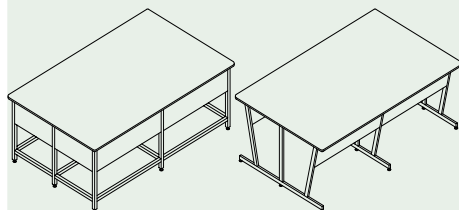

3000 x 1200 x 900 mm ht. (10x4x3 ft)
2 module

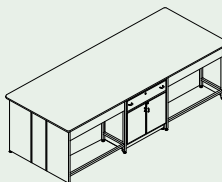

3000 x 1200 x 900 mm ht. (10x4x3 ft)
4 module

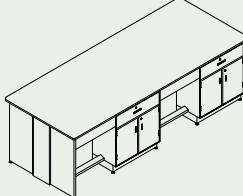

3000 x 1200 x 900 mm ht. (10x4x3 ft)
6 module

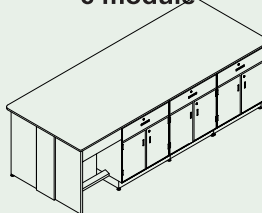

3100 x 1200 x 900 mm ht. (10x4x3 ft)
8 module

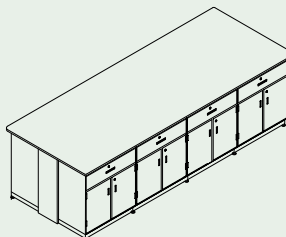

3000 x 1200 x 900 mm ht. (10x4x3 ft)

(A)

(B)

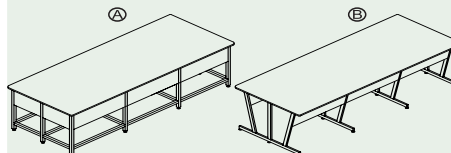

3000 x 1500 x 900 mm ht. (10x5x3 ft)
2 module

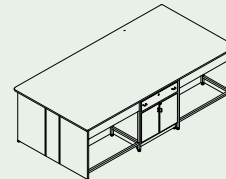

3000 x 1500 x 900 mm ht. (10x5x3 ft)
4 module

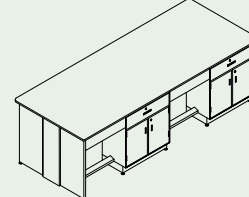

3000 x 1500 x 900 mm ht. (10x5x3 ft)
6 module

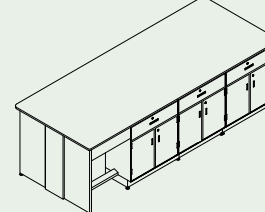

3100 x 1500 x 900 mm ht. (10x5x3 ft)
8 module

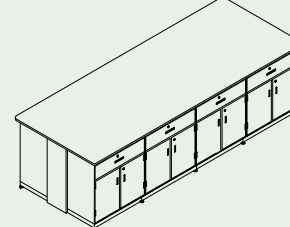

3000 x 1500 x 900 mm ht. (10x5x3feet)

(A)

(B)

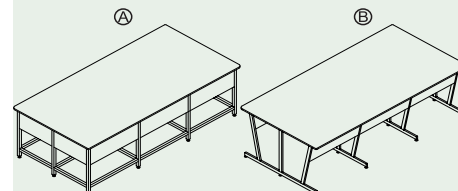

ISLAND TABLE

METROLABS

Lab Furniture | Fume Hood | Laminar Airflow | Storage Cupboard

We are there **when** you need us !

3600 x 1200 x 900 mm ht. (12 x 4 x 3 ft)
4 module

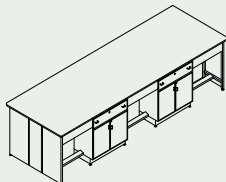

3600 x 1200 x 900 mm ht. (12x4x3 ft)
6 module (A) (B)

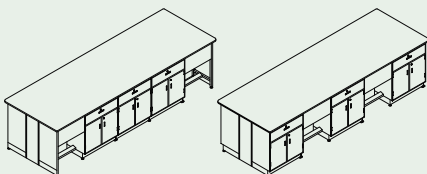

3600 x 1200 x 900 mm ht. (12x4x3 ft)
8 module

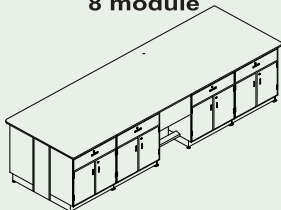

3600 x 1200 x 900 mm ht. (12x4x3 ft)
10 module

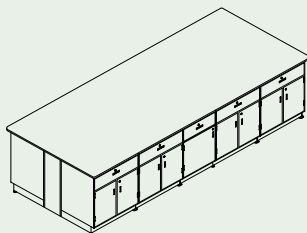

3600 x 1200 x 900 mm ht. (12x4x3 feet)

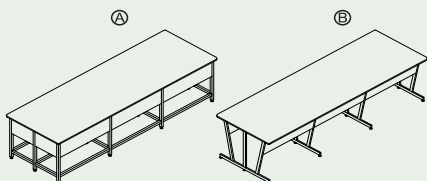

3600 x 1500 x 900 mm ht. (12 x 5 x 3 ft)
4 module

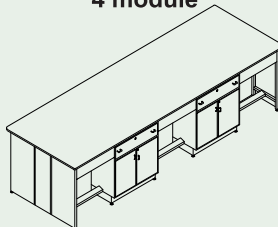

3600 x 1500 x 900 mm ht. (12 x 5 x 3 ft)
6 module (A) (B)

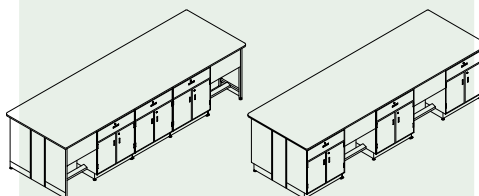

3600 x 1500 x 900 mm ht. (12 x 5 x 3 ft)
8 module

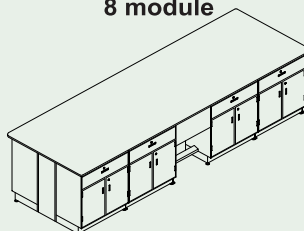

3600 x 1500 x 900 mm ht. (12 x 5 x 3 ft)
10 module

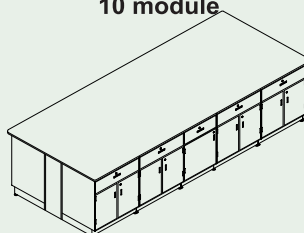

3600 x 1500 x 900 mm ht. (12x5x3feet)

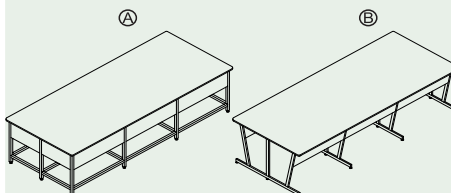

WALL SIDE TABLE

METROLABS

Lab Furniture | Fume Hood | Laminar Airflow | Storage Cupboard

We are there **when** you need us !

1200 x 600 x 900 mm ht. (4 x 2 x 3 ft)
1 module

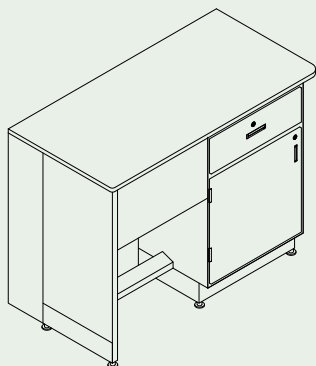

1200 x 750 x 900 mm ht. (4 x 2.5 x 3 ft)
1 module

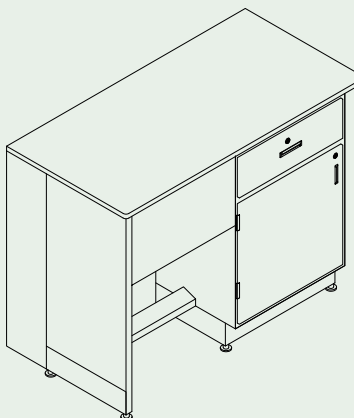

1500 x 600 x 900 mm ht. (5 x 2 x 3 ft)
1 module

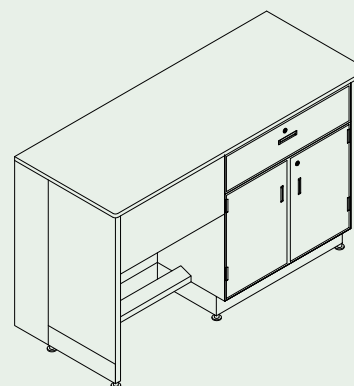

1200 x 600 x 900 mm ht. (4 x 2 x 3 ft)
2 module

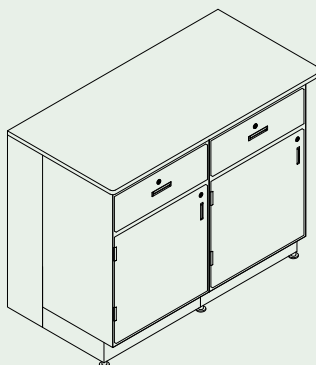

1200 x 750 x 900 mm ht. (4 x 2.5 x 3 ft)
2 module

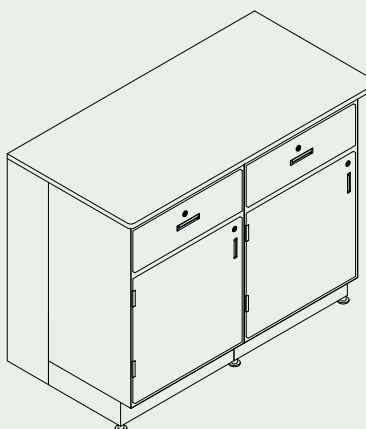

1600 x 600 x 900 mm ht. (5 x 2 x 3 ft)
2 module

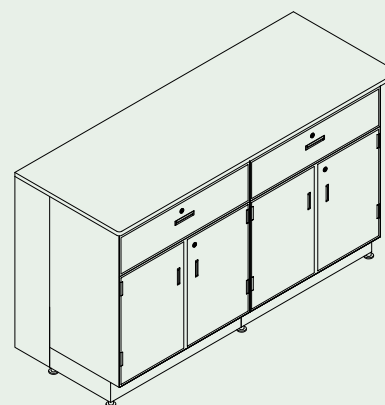

1200 x 600 x 900 mm ht. (4 x 2 x 3 ft)

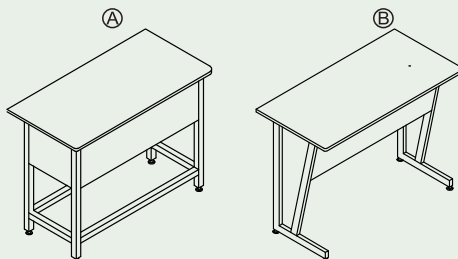

1200 x 750 x 900 mm ht. (4 x 2.5 x 3 ft)

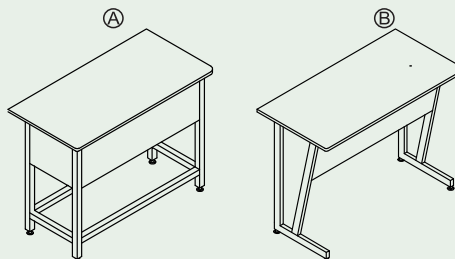

1500 x 600 x 900 mm ht. (5 x 2 x 3 ft)

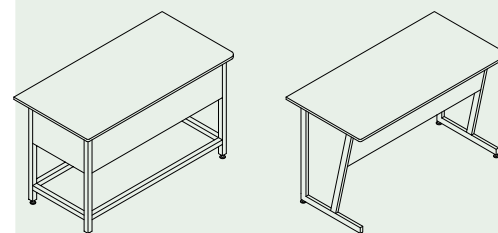

WALL SIDE TABLE

METROLABS

Lab Furniture | Fume Hood | Laminar Airflow | Storage Cupboard

We are there **when** you need us !

1500 x 900 x 900 mm ht. (5 x 3 x 3 ft)
1 module

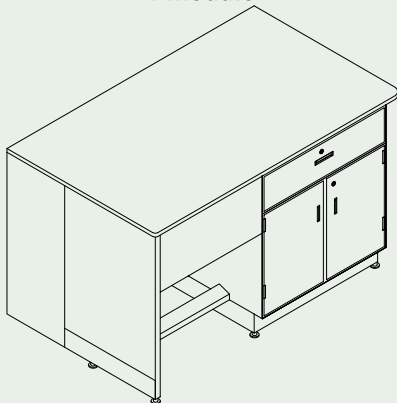

1800 x 600 x 900 mm ht. (6 x 2 x 3 ft)
1 module

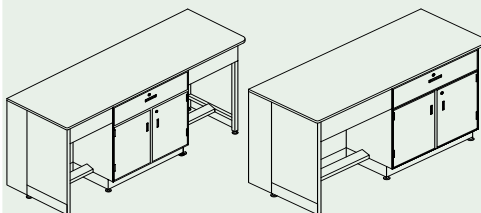

1800 x 750 x 900 mm ht. (6 x 2.5 x 3 ft)
1 module

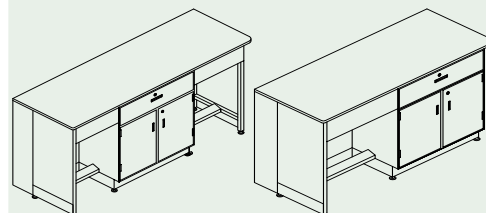

1600 x 900 x 900 mm ht. (5 x 3 x 3 ft)
2 module

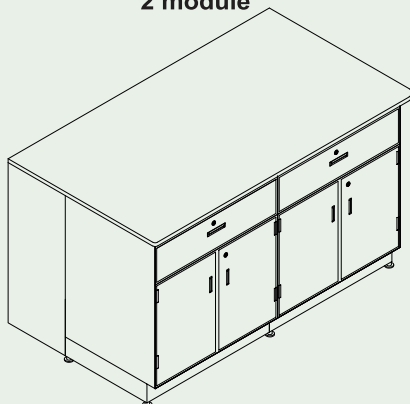

1800 x 600 x 900 mm ht. (6 x 2 x 3 ft)
2 module

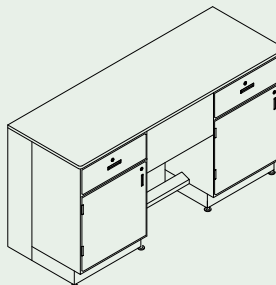

1800 x 750 x 900 mm ht. (6 x 2.5 x 3 ft)
2 module

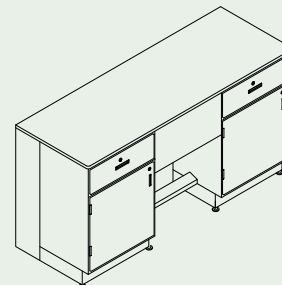

1500 x 900 x 900 mm ht. (5 x 3 x 3 ft)

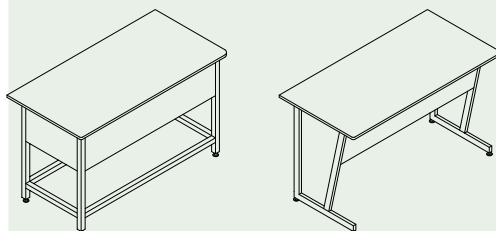

1750 x 600 x 900 mm ht. (6 x 2 x 3 ft)
3 module

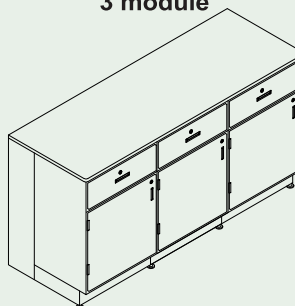

1750 x 750 x 900 mm ht. (6 x 2.5 x 3 ft)
3 module

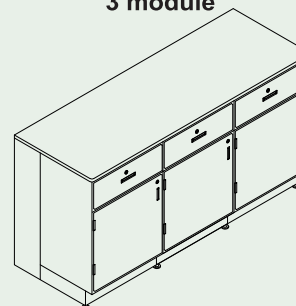

1800 x 600 x 900 mm ht. (6 x 2 x 3 ft)

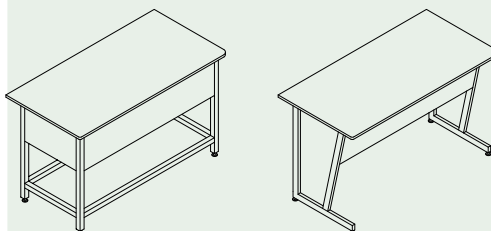

1800 x 750 x 900 mm ht. (6 x 2.5 x 3 ft)

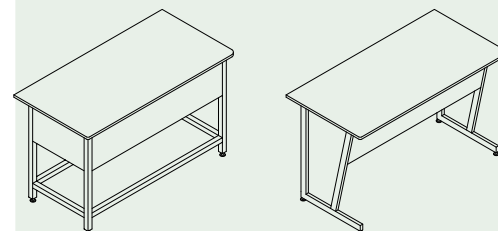

WALL SIDE TABLE

METROLABS

Lab Furniture | Fume Hood | Laminar Airflow | Storage Cupboard

We are there **when** you need us !

1800 x 900 x 900 mm ht. (6 x 3 x 3 ft)
1 module

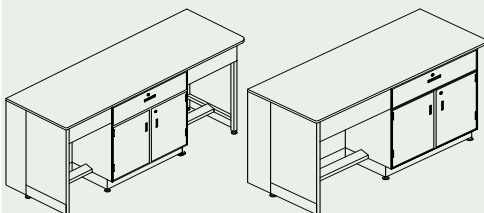

1800 x 900 x 900 mm ht. (6 x 3 x 3 ft)
2 module

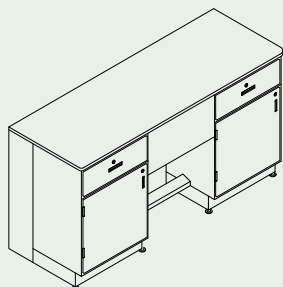

1750 x 900 x 900 mm ht. (6 x 3 x 3 ft)
3 module

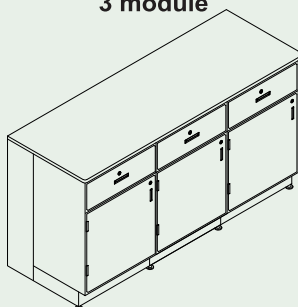

1800 x 900 x 900 mm ht. (6 x 3 x 3 ft)

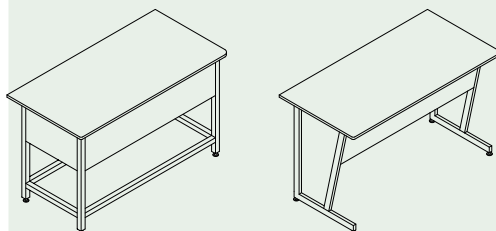

2100 x 600 x 900 mm ht. (7 x 2 x 3 ft)
1 module

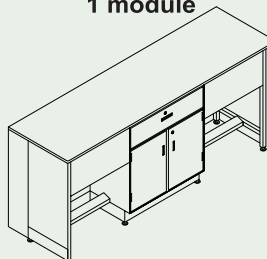

2100 x 600 x 900 mm ht. (7 x 2 x 3 ft)
2 module

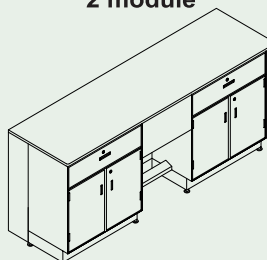

2100 x 600 x 900 mm ht. (7 x 2 x 3 ft)
3 module

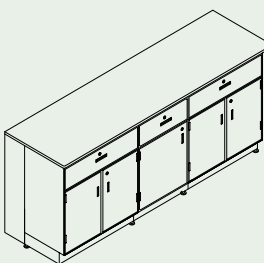

2100 x 600 x 900 mm ht. (7 x 2 x 3 ft)

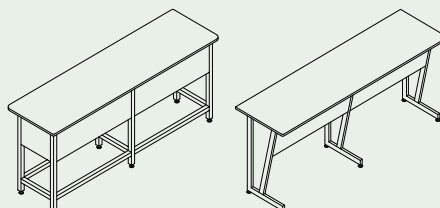

2100 x 750 x 900 mm ht. (7 x 2.5 x 3 ft)
1 module

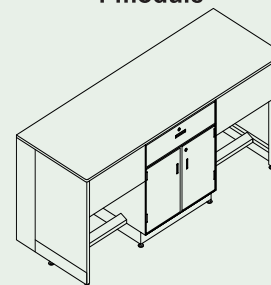

2100 x 750 x 900 mm ht. (7 x 2.5 x 3 ft)
2 module

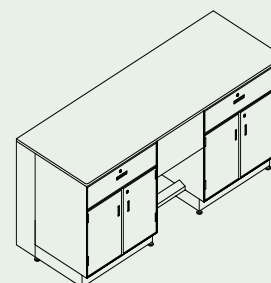

2100 x 750 x 900 mm ht. (7 x 2.5 x 3 ft)
3 module

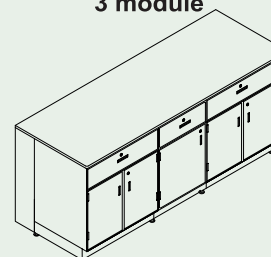

2100 x 750 x 900 mm ht. (7 x 2.5 x 3 ft)

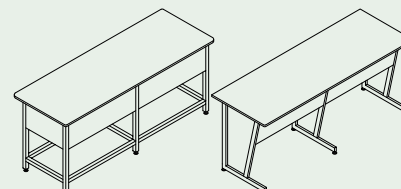

WALL SIDE TABLE

METROLABS

Lab Furniture | Fume Hood | Laminar Airflow | Storage Cupboard

We are there **when** you need us !

2100 x 900 x 900 mm ht. (7 x 3 x 3 ft)
1 module

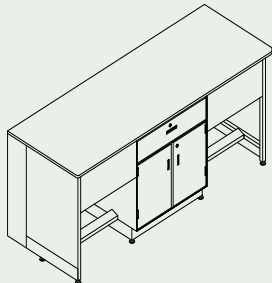

2100 x 900 x 900 mm ht. (7 x 3 x 3 ft)
2 module

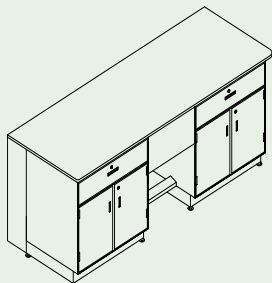

2100 x 900 x 900 mm ht. (7 x 3 x 3 ft)
3 module

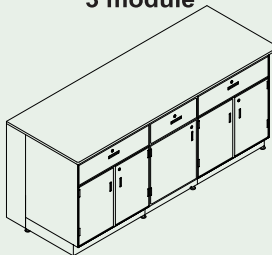

2100 x 900 x 900 mm ht. (7 x 3 x 3 ft)

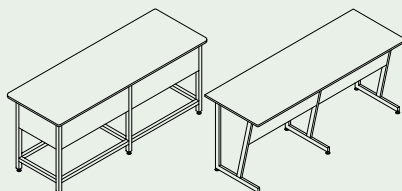

2400 x 600 x 900 mm ht. (8 x 2 x 3 ft)
1 module

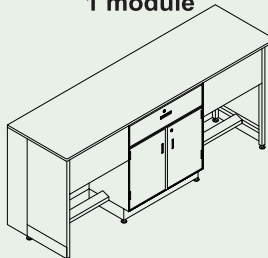

2400 x 600 x 900 mm ht. (8 x 2 x 3 ft)
2 module

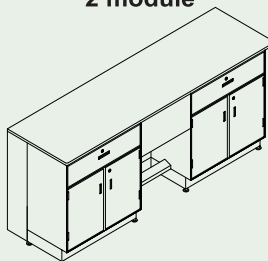

2400 x 600 x 900 mm ht. (8 x 2 x 3 ft)
3 module

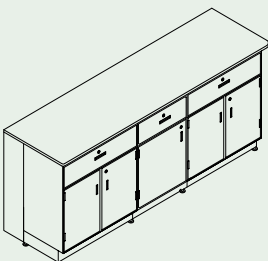

2400 x 600 x 900 mm ht. (8 x 2 x 3 ft)

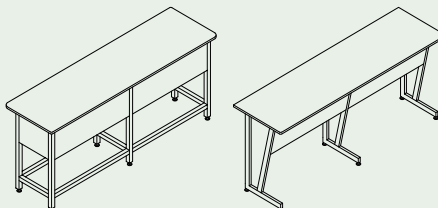

2400 x 750 x 900 mm ht. (8 x 2.5 x 3 ft)
1 module

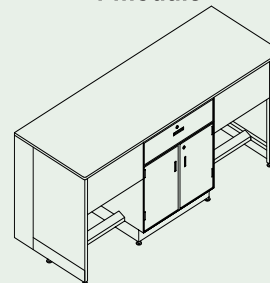

2400 x 750 x 900 mm ht. (8 x 2.5 x 3 ft)
2 module

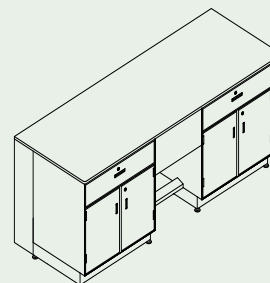

2350 x 750 x 900 mm ht. (8 x 2.5 x 3 ft)
3 module

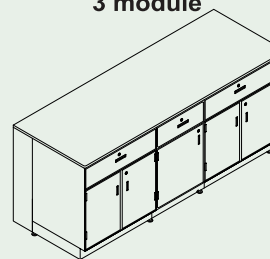

2400 x 750 x 900 mm ht. (8 x 2.5 x 3 ft)

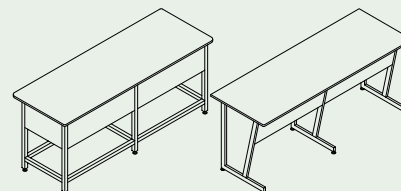

WALL SIDE TABLE

2400 x 900 mm (8 x 3 ft.)

METROLABS

Lab Furniture | Fume Hood | Laminar Airflow | Storage Cupboard

We are there **when** you need us !

2400 x 900 x 900 mm ht. (8 x 3 x 3 ft)
1 module

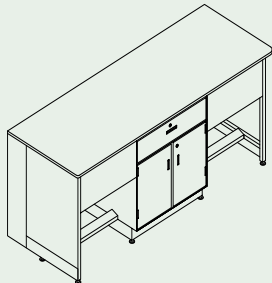

2400 x 900 x 900 mm ht. (8 x 3 x 3 ft)
2 module

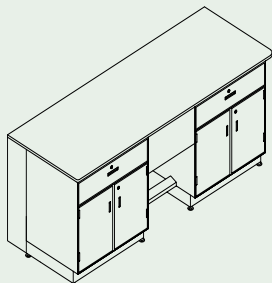

2350 x 900 x 900 mm ht. (8 x 3 x 3 ft)
3 module

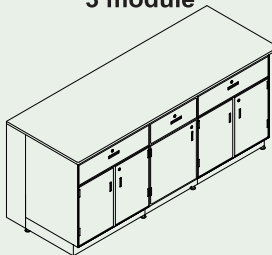

2400 x 900 x 900 mm ht. (4 x 3 x 3 ft)

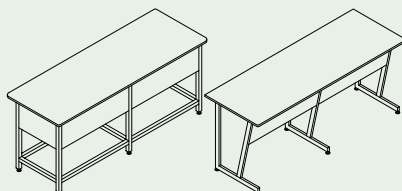

2700 x 600 x 900 mm ht. (9 x 2 x 3 ft)
1 module

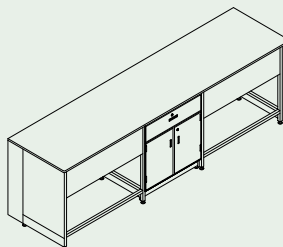

2700 x 600 x 900 mm ht. (9 x 2 x 3 ft)
2 module

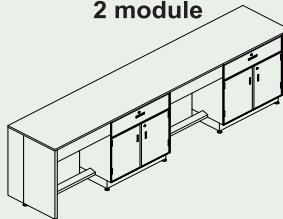

2700 x 600 x 900 mm ht. (9 x 2 x 3 ft)
3 module

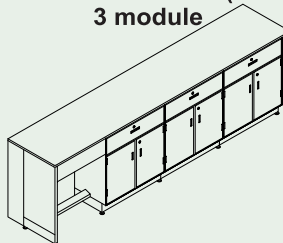

2700 x 600 x 900 mm ht. (9 x 2 x 3 ft)

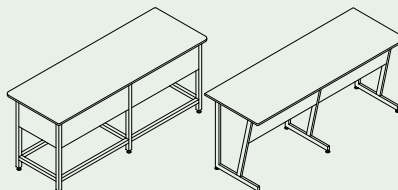

2700 x 750 x 900 mm ht. (9 x 2.5 x 3 ft)
1 module

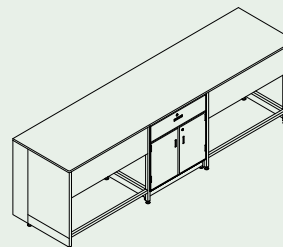

2700 x 750 x 900 mm ht. (9 x 2.5 x 3 ft)
2 module

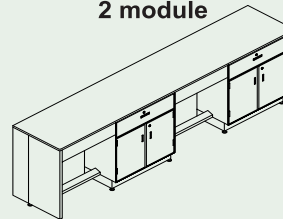

2700 x 750 x 900 mm ht. (9 x 2.5 x 3 ft)
3 module

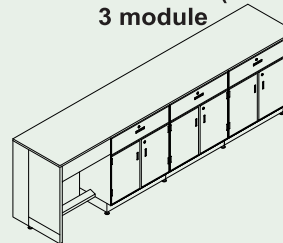

2700 x 750 x 900 mm ht. (9 x 2.5 x 3 ft)

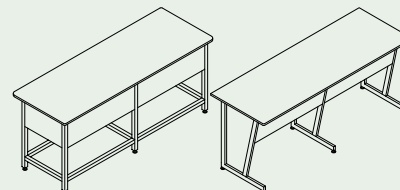

WALL SIDE TABLE

2700 x 900 mm (9 x 3 ft.)

METROLABS

Lab Furniture | Fume Hood | Laminar Airflow | Storage Cupboard

We are there **when** you need us !

2700 x 900 x 900 mm ht. (9 x 3 x 3 ft)
1 module

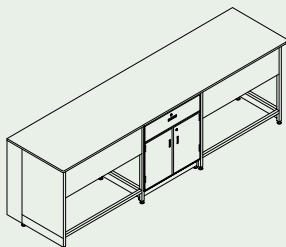

2700 x 900 x 900 mm ht. (9 x 3 x 3 ft)
2 module

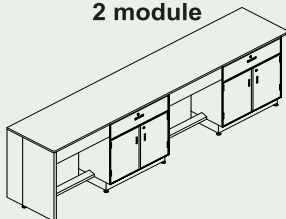

2700 x 900 x 900 mm ht. (9 x 3 x 3 ft)
3 module

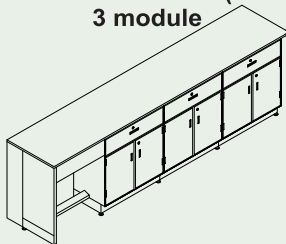

2700 x 900 x 900 mm ht. (9 x 3 x 3 ft)

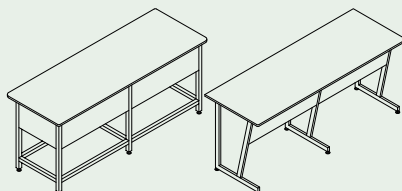

3000 x 600 x 900 mm ht. (10 x 2 x 3 ft)
1 module

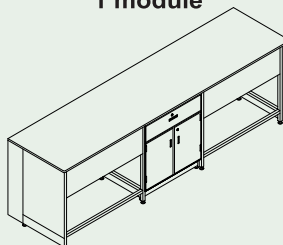

3000 x 600 x 900 mm ht. (10 x 2 x 3 ft)
2 module

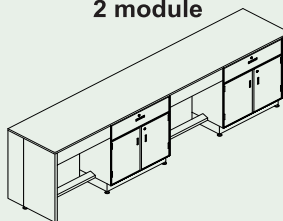

3000 x 600 x 900 mm ht. (10 x 2 x 3 ft)
3 module

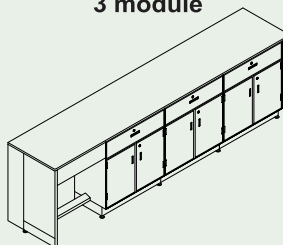

3100 x 900 x 900 mm ht. (10 x 3 x 3 ft)
4 module

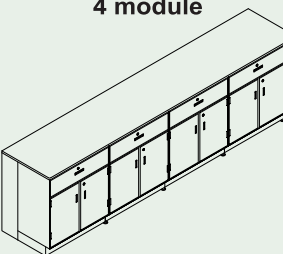

3000 x 600 x 900 mm ht. (10 x 2 x 3 ft)



3000 x 750 x 900 mm ht. (10 x 2.5 x 3 ft)
1 module

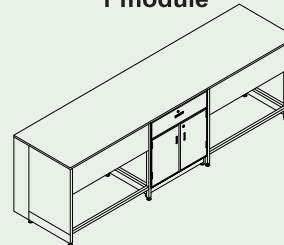

3000 x 750 x 900 mm ht. (10 x 2.5 x 3 ft)
2 module

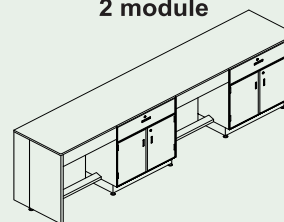

3000 x 750 x 900 mm ht. (10 x 2.5 x 3 ft)
3 module

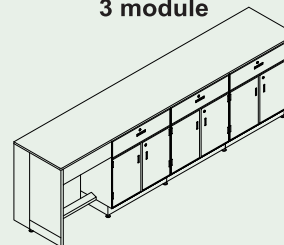

3100 x 900 x 900 mm ht. (10 x 3 x 3 ft)
4 module

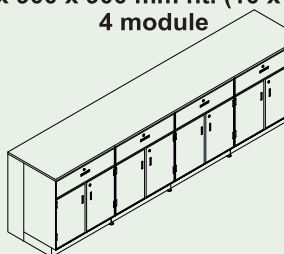

3000 x 750 x 900 mm ht. (10 x 2.5 x 3 ft)



WALL SIDE TABLE

3000 x 900 mm (10 x 3 ft.)

METROLABS

Lab Furniture | Fume Hood | Laminar Airflow | Storage Cupboard

We are there **when** you need us !

3000 x 900 x 900 mm ht. (10 x 3 x 3 ft)
1 module

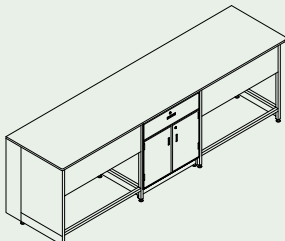

3000 x 900 x 900 mm ht. (10 x 3 x 3 ft)
2 module

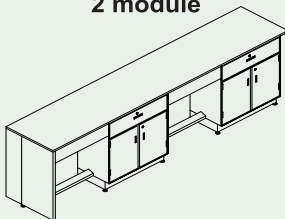

3000 x 900 x 900 mm ht. (10 x 3 x 3 ft)
3 module

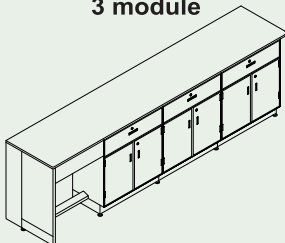

3100 x 900 x 900 mm ht. (10 x 3 x 3 ft)
4 module

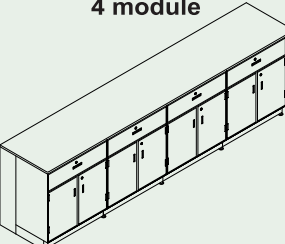

3000 x 900 x 900 mm ht. (10 x 3 x 3 ft)

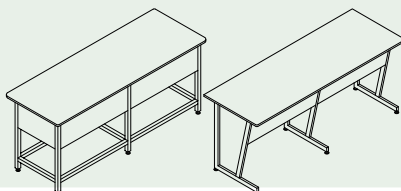

3600 x 600 x 900 mm ht.
(12 x 2 x 3 ft)
1 module

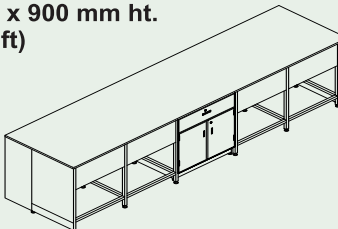

3600 x 600 x 900 mm ht.
(12 x 2 x 3 ft)
2 module

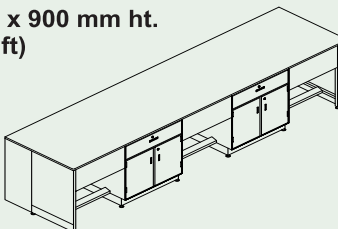

3600 x 600 x 900 mm ht.
(12 x 2 x 3 ft)
3 module

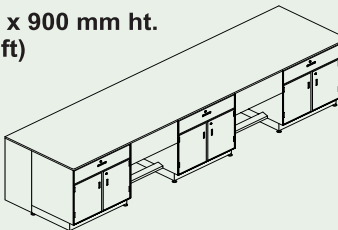

3600 x 600 x 900 mm ht.
(12 x 2 x 3 ft)
4 module

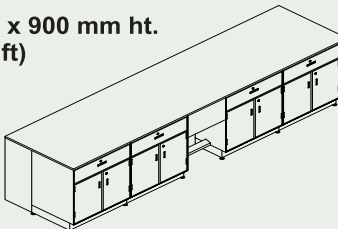

3600 x 600 x 900 mm ht.
(12 x 2 x 3 ft)
5 module

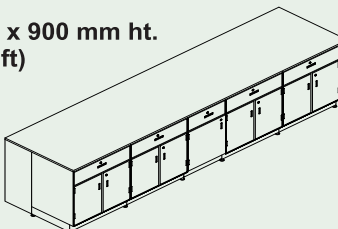

3600 x 600 x 900 mm ht.
(12 x 2 x 3 ft)

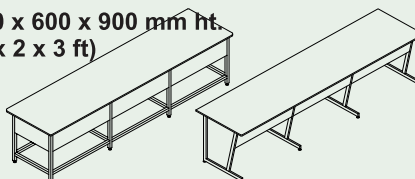

3600 x 750 x 900 mm ht.
(12 x 2.5 x 3 ft)
1 module

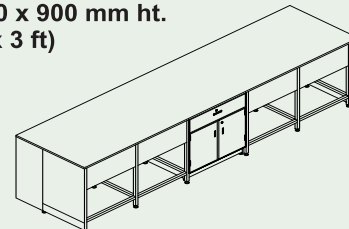

3600 x 750 x 900 mm ht.
(12 x 2.5 x 3 ft)
2 module

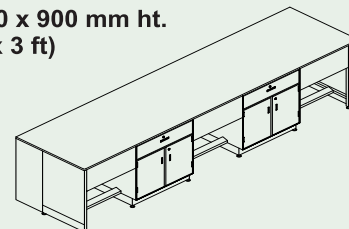

3600 x 750 x 900 mm ht.
(12 x 2.5 x 3 ft)
3 module

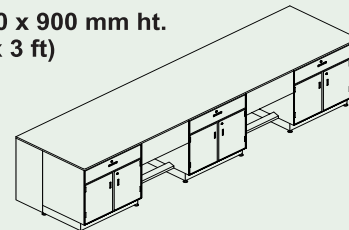

3600 x 750 x 900 mm ht.
(12 x 2.5 x 3 ft)
4 module

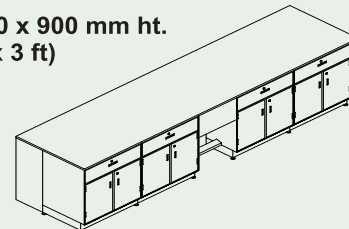

3600 x 750 x 900 mm ht.
(12 x 2.5 x 3 ft)
5 module

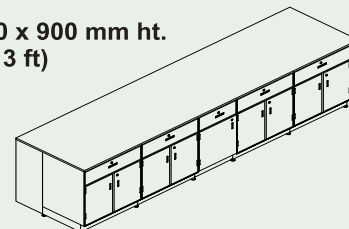

3600 x 750 x 900 mm ht.
(12 x 2.5 x 3 ft)

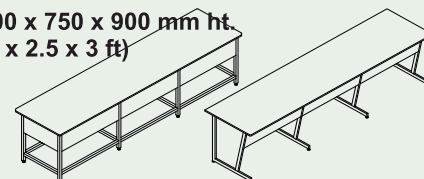

WALL SIDE TABLE

3600 x 900 mm (12 x 3 ft.)

3600 x 900 x 900 mm ht.
(12 x 3 x 3 ft)
1 module

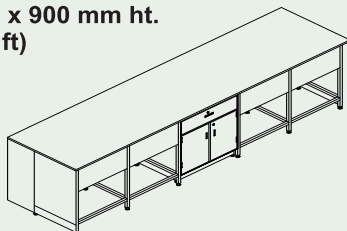

3600 x 900 x 900 mm ht.
(12 x 3 x 3 ft)
2 module

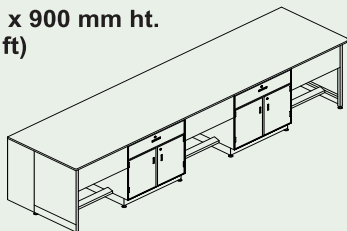

3600 x 900 x 900 mm ht.
(12 x 3 x 3 ft)
3 module

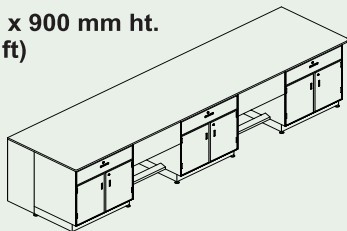

3600 x 900 x 900 mm ht.
(12 x 3 x 3 ft)
4 module

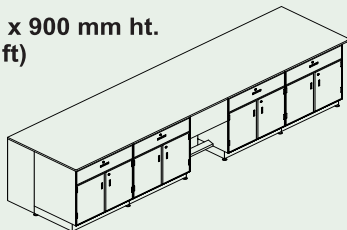

3600 x 900 x 900 mm ht.
(12 x 3 x 3 ft)
5 module

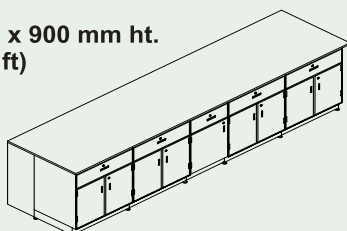

3600 x 900 x 900 mm ht.
(12 x 3 x 3 ft)

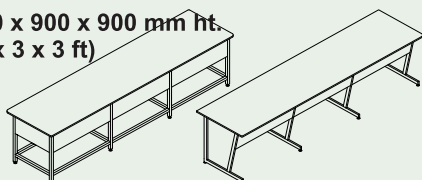

METROLABS

Lab Furniture | Fume Hood | Laminar Airflow | Storage Cupboard

We are there **when** you need us !



SINK UNITS

METROLABS

Lab Furniture | Fume Hood | Laminar Airflow | Storage Cupboard

We are there **when** you need us !

850 x 750 x 900 mm ht. (3 x 2.5 x 3 ft)

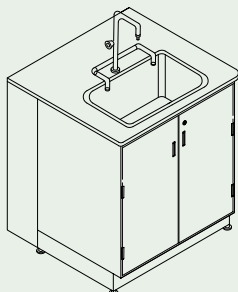

850 x 900 x 900 mm ht. (3 x 3 x 3 ft)

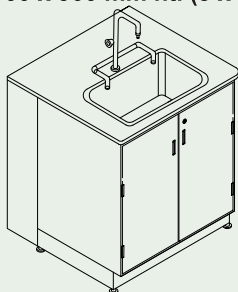

850 x 900 x 900 mm ht. (3 x 3 x 3 ft)

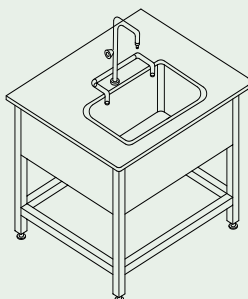

850 x 900 x 900 mm ht. (3 x 3 x 3 ft)

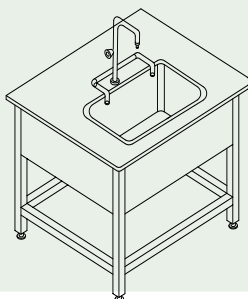

1600 x 750 x 900 mm ht. (3 x 2.5 x 3 ft)

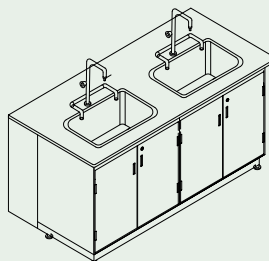

1600 x 900 x 900 mm ht. (3 x 3 x 3 ft)

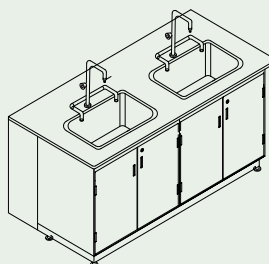

1500 x 750 x 900 mm ht. (5 x 2.5 x 3 ft)

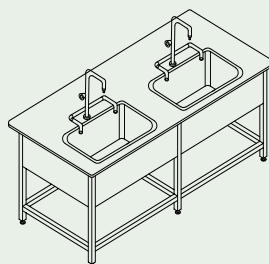

1500 x 900 x 900 mm ht. (5 x 3 x 3 ft)

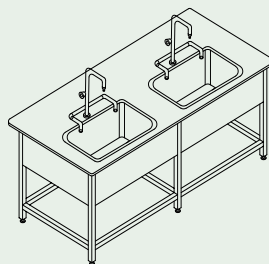

1500 x 750 x 900 mm ht. (3 x 2.5 x 3 ft)

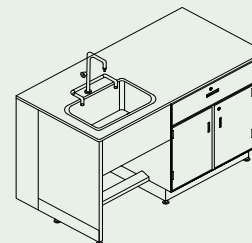

1500 x 900 x 900 mm ht. (3 x 3 x 3 ft)

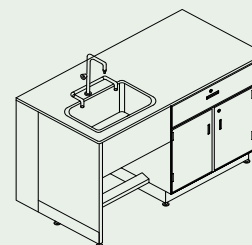

1600 x 750 x 900 mm ht. (5 x 2.5 x 3 ft)

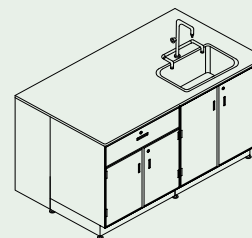

1600 x 900 x 900 mm ht. (5 x 3 x 3 ft)

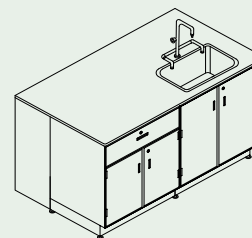

METROLABS

Lab Furniture | Fume Hood | Laminar Airflow | Storage Cupboard

We are there **when** you need us !



ANTI-VIBRATION TABLE

METROLABS

Lab Furniture | Fume Hood | Laminar Airflow | Storage Cupboard

We are there **when** you need us !

600 x 600 x 900 mm ht. (2 x 2 x 3 ft)
750 x 750 x 900 mm ht. (2.5 x 2.5 x 3 ft)
900 x 900 x 900 mm ht. (3 x 3 x 3 ft)

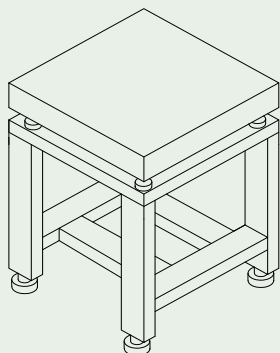

600 x 750 x 900 mm ht. (2 x 2.5 x 3 ft)
750 x 900 x 900 mm ht. (2 x 2.5 x 3 ft)

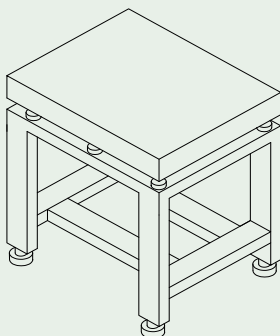

1200 x 600 x 900 mm ht. (2 x 2.5 x 3 ft)
1200 x 750 x 900 mm ht. (2 x 2.5 x 3 ft)
1200 x 900 x 900 mm ht. (2 x 2.5 x 3 ft)

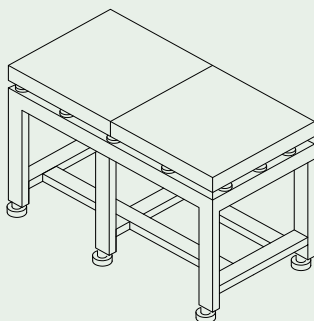

FUME HOOD CABINET

METROLABS

Lab Furniture | Fume Hood | Laminar Airflow | Storage Cupboard

We are there **when** you need us !

1200 x 750 x 1500 mm ht. (4 x 2.5 x 5 ft) - Top only
 1200 x 900 x 1500 mm ht. (4 x 3 x 5 ft) - Top only
 1500 x 750 x 1500 mm ht. (5 x 2.5 x 5 ft) - Top only
 1500 x 900 x 1500 mm ht. (5 x 3 x 5 ft) - Top only
 1800 x 750 x 1500 mm ht. (6 x 2.5 x 5 ft) - Top only
 1800 x 900 x 1500 mm ht. (6 x 3 x 5 ft) - Top only

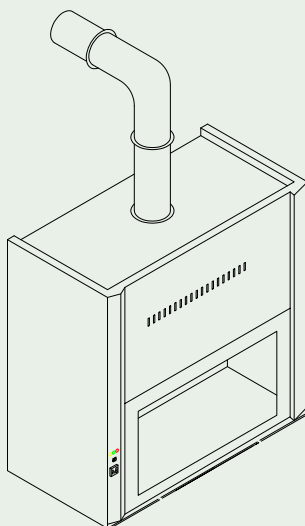

900 x 750 x 2400 mm ht. (3 x 2.5 x 8 ft)
 900 x 900 x 2400 mm ht. (3 x 3 x 8 ft)

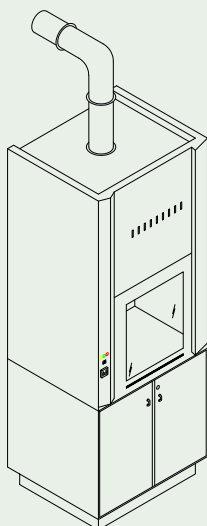

1200 x 750 x 2400 mm ht. (4 x 2.5 x 8 ft)
 1200 x 900 x 2400 mm ht. (4 x 3 x 8 ft)

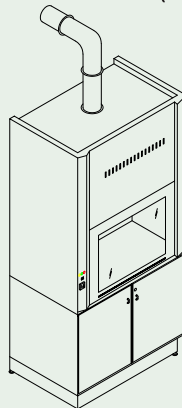

1500 x 750 x 2400 mm ht. (5 x 2.5 x 8 ft)
 1500 x 900 x 2400 mm ht. (5 x 3 x 8 ft)

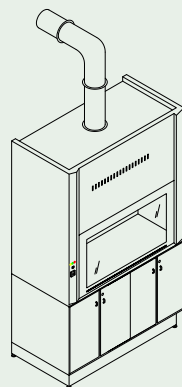

1800 x 750 x 2400 mm ht. (6 x 2.5 x 8 ft)
 1800 x 900 x 2400 mm ht. (6 x 2.5 x 8 ft)

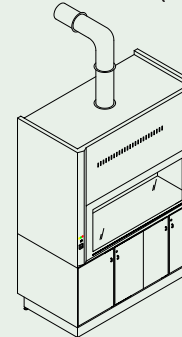

STORAGE CUPBOARDS

METROLABS

Lab Furniture | Fume Hood | Laminar Airflow | Storage Cupboard

We are there **when** you need us !

900 x 450 x 1500 mm ht. (3 x 1.5 x 5 ft)
900 x 450 x 1800 mm ht. (3 x 1.5 x 6 ft)
900 x 450 x 2400 mm ht. (3 x 1.5 x 8 ft)
Without Duct (Exhaust)

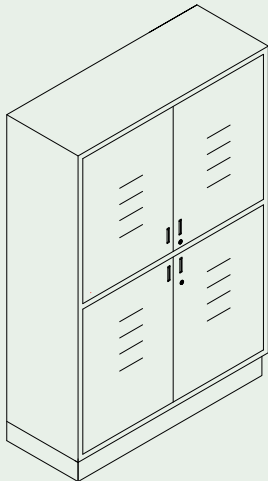

900 x 450 x 1500 mm ht. (3 x 1.5 x 5 ft)
900 x 450 x 1800 mm ht. (3 x 1.5 x 6 ft)
900 x 450 x 2400 mm ht. (3 x 1.5 x 8 ft)
With Duct. Motor and blower (Exhaust)

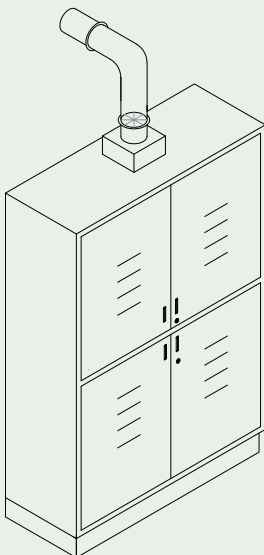

650 x 250 x 600 mm ht. (2.16 x 0.83 x 2 ft)
900 x 250 x 600 mm ht. (3 x 0.83 x 2 ft)
Reagent Racks

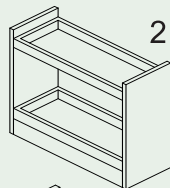

2 Tire

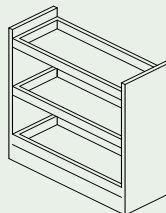
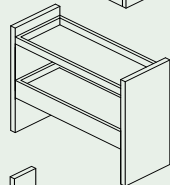

3 Tire

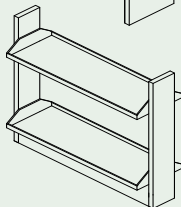

600 x 300 x 600 mm ht. (2 x 1 x 2 ft)
900 x 300 x 600 mm ht. (3 x 1 x 2 ft)
Wall Storage Cupboards

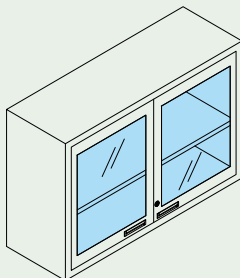

1 plate,
2 partitions

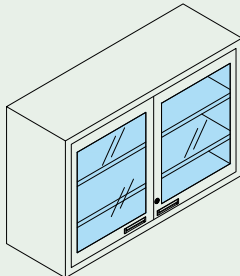

2 plates,
3 partitions

900 x 450 x 1800 mm ht. (3 x 1.5 x 6 ft)
1200 x 450 x 1800 mm ht. (4 x 1.5 x 6 ft)
1500 x 450 x 1800 mm ht. (5 x 1.5 x 6 ft)

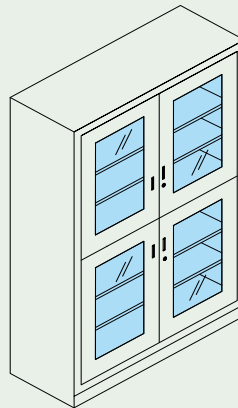

3 plates,
4 partitions

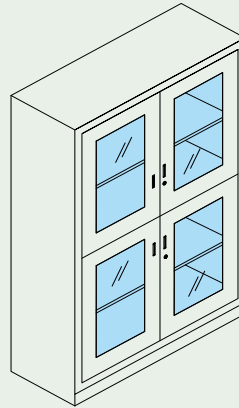

5 plates,
6 partitions

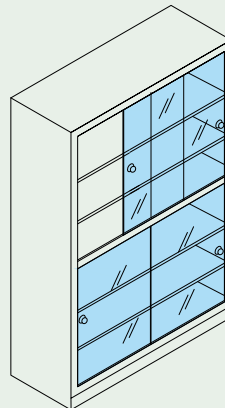
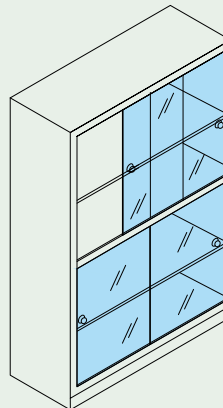

STORAGE CUPBOARD / RACKS

METROLABS

Lab Furniture | Fume Hood | Laminar Airflow | Storage Cupboard

We are there **when** you need us !

900 x 450 x 1800 mm ht. (3 x 1.5 x 6 ft)
1200 x 450 x 1800 mm ht. (4 x 1.5 x 6 ft)
1500 x 450 x 1800 mm ht. (5 x 1.5 x 6 ft)

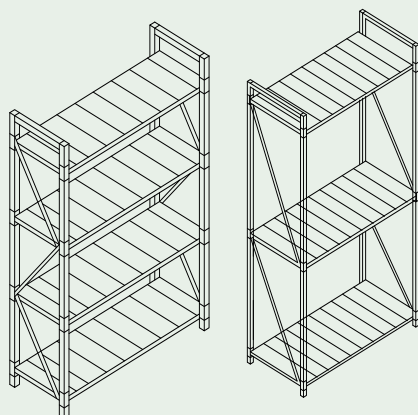
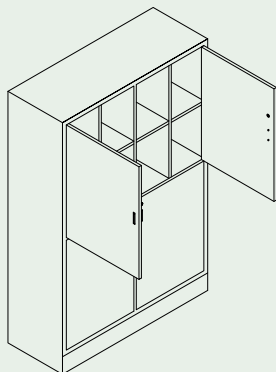
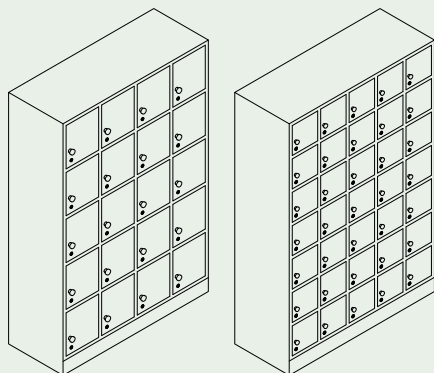

4 plates,
4 partitions

3 plates,
3 partitions



CENTER / ISLAND LAB TABLES

Laboratory Centre Table that are performance based and have high strength. Our entire range is abrasion resistant in nature and is offered with standard configurations.

Granite top island Tables as per customers required size, and specification with sink, water tap, reagent rack on top with draw and cupboard under ben modules.

The construction using thick and superior grade GI sheet also make these deliver optimum service life standards. Completely Made of pretreated Galvanised Iron (GI) sheets with epoxy powder coated finish. Fully polished and round edged black granite working top. Bottom support stand of floor leveling screws. Shutters provided in these benches fitted with hinges with shutter modules having removable shelves. Modules for sink tables designed for fitment of sinks. Can manufacture these in different model options depends upon the customer's requirements. Matt finish provides resistivity against scratch. Resistance against chemicals and heat. Dimensional stability leads to effortless installation.

This Laboratory Tables come with locking arrangements and are catering to the demands of industry sectors like bio chemistry, diagnostics labs, biotechnology, tissue culture, pharma industry, healthcare industry. Other than this, these also find usage in labs established in food processing, semiconductors, life science and chemical industry sectors.

Features:

- High in demand
- Superior quality
- Reasonable price.

Accessories to add value to the table:

- Telescopic rail for drawers
- PP Sink with swan neck taps
- Imported CED coated concealed Hinges
- SS curved handle
- Godrej or equivalent cam locks



WALL SIDE LAB TABLES

we are affianced in offering Laboratory Working Benches. The offered benches are mainly assembled in for laboratory and research centres and systems. Our offered benches are highly demanded in laboratories, hospitals, and research institutions. Additional, the offered benches are manufactured by making use of premium quality raw materials and modern machinery by our experts. We offer these benches in several sizes and specifications in order to meet changing needs of our clients. Granite top Wall side Tables as per customers required size, Shape like "L", "U" and specifications with sink, water tap, reagent racks, Electrical Boxes on top with draw and cupboard under ben modules.

The construction using thick and superior grade GI sheet also make these deliver optimum service life standards. Completely Made of pretreated Galvanised Iron (GI) sheets with epoxy powder coated finish. Fully polished and round edged black granite working top. Bottom support stand of floor leveling screws. Shutters provided in these benches fitted with hinges with shutter modules having removable shelves. Modules for sink tables designed for fitment of sinks. Can manufacture these in different model options depends upon the customer's requirements. Matt finish provides resistivity against scratch. Resistance against chemicals and heat. Dimensional stability leads to effortless installation.

This Laboratory Tables come with locking arrangements and are catering to the demands of industry sectors like bio chemistry, diagnostics labs, biotechnology, tissue culture, pharma industry, healthcare industry. Other than this, these also find usage in labs established in food processing, semiconductors, life science and chemical industry sectors.

We are known for providing world-class Laboratory working Bench, which is available in a wide array consisting of different designs and dimensions. Our Laboratory Benches are made as per the scientific specifications and are ergonomically designed to give a comfortable working space.

Quality:

Black Granite

Epoxy polyester

Pure Polyester powder coating

Pure Epoxy powder coating on request.

Known for:

Contemporary designing

Sturdy construction

Scratch and bump resistance

Chemical resistance



MOVEABLE UNDER BENCH MODULES

Granite top Wall side Tables as per customers required size, Shape like "L", "U" and specifications with sink, water tap, reagent racks, Electrical Boxes on top with draw and cupboard under ben modules.

The construction using thick and superior grade GI sheet also make these deliver optimum service life standards.

Completely Made of pretreated Galvanised Iron (GI) sheets with epoxy powder coated finish. Fully polished and round edged black granite working top. Bottom support stand of floor leveling screws. Shutters provided in these benches fitted with hinges with shutter modules having removable shelves. Modules for sink tables designed for fitment of sinks. Can manufacture these in different model options depends upon the customer's requirements. Matt finish provides resistivity against scratch. Resistance against chemicals and heat. Dimensional stability leads to effortless installation.

This Laboratory Tables come with locking arrangements and are catering to the demands of industry sectors like bio chemistry, diagnostics labs, biotechnology, tissue culture, pharma industry, healthcare industry. Other than this, these also find usage in labs established in food processing, semiconductors, life science and chemical industry sectors.

POINTS TO CONSIDER

- ☐ Flooring
- ☐ Ventilation
- ☐ Existing electrical lines
- ☐ Special earthing
- ☐ Lighting arrangements
- ☐ Keyboard tray
- ☐ CPU holder / trolley



ANTI-VIBRATION TABLE

Made of finely polished epoxy resin coated 18 mm +/- 2 mm thick black Color Granite with rounded edges with Bottom 12mm of Plywood. These Cupboard will be provided with bottom cupboard and lockable doors and aesthetic powder coated handles. Made of 1mm thick pre-coated Galvanized iron Sheet (JSW / TATA Steel – GI Sheet) and completely finished with epoxy powder coating.

Structure made up of 1 mm GI Sheet and hollow CRCA tubing size of 100 x 50 mm x 1 mm thick. Completely Made of pretreated Galvanised Iron (GI) sheets with epoxy powder coated finish. Fully polished and round edged black granite working top. Bottom support stand of floor leveling screws. Shutters provided in these benches fitted with hinges with shutter modules having removable shelves. Modules for sink tables designed for fitment of sinks. Can manufacture these in different model options depends upon the customer's requirements. Matt finish provides resistivity against scratch. Resistance against chemicals and heat. Dimensional stability leads to effortless installation.

This Laboratory Tables come with locking arrangements and are catering to the demands of industry sectors like bio chemistry, diagnostics labs, biotechnology, tissue culture, pharma industry, healthcare industry. Other than this, these also find usage in labs established in food processing, semiconductors, life science and chemical industry sectors.

POINTS TO CONSIDER

- ☐ Flooring
- ☐ Ventilation
- ☐ Existing electrical lines
- ☐ Special earthing
- ☐ Lighting arrangements
- ☐ Keyboard tray
- ☐ CPU holder / trolley



STAINLESS STEEL LAB FURNITURE

We supply top quality brushed satin stainless steel laboratory furniture Cabinets, Sinks, Worktops, Shelving and trolleys to meet your specific needs and requirements.

The stainless steel sinks and basins we design and produce are a great choice for any laboratory environment. Products are especially suited for use in Quality Assurance, Quality Control and R & D Labs where effective and durable solutions are required. You can rely on our sinks not to rust or corrode and they are durable enough to withstand years of hard use and even abuse. We supply stainless steel wash basins and sinks in conjunction with stainless steel worktops, cabinets, shelving and trolleys, including stainless steel mirrors.

Metrolabs made to measure stainless steel base cabinets, wall cabinets, drawer cabinets and tall cabinets are made order in any size or configuration. Doors are either plain with stainless steel 'D' handles or for use with hardware by others; with continuous recessed handles (vertical or horizontal); or with back-slope edge. Units are strong and durable, but also aesthetically pleasing, with clean and professional appearance.

We offer a wide range of bespoke products all manufactured from high quality 304 or 316 grade stainless steel. Although we offer a limited range of standard products, the vast majority are fully bespoke and custom made to order. Our product offerings are broad and deep including chemical fume hoods, laboratory countertops, flexible lab furniture, and lab accessories and safety equipment. And product customization is "standard" with each project.

POINTS TO CONSIDER

- ☐ Flooring
- ☐ Ventilation
- ☐ Existing electrical lines
- ☐ Special earthing
- ☐ Lighting arrangements
- ☐ Keyboard tray
- ☐ CPU holder / trolley



Top only Stainless Steel

STORAGE RACK CUPBOARDS



Floor Standing
Cupboard



Open Rack



Wall Cupboard



Lab Coat and Shoe rack



Pigeon hole rack



File Storage Rack

STORAGE RACK CUPBOARDS

Storage cupboards are an essential requirement in all labs. These cupboards are made up of Galvanised Iron (GI) metal sheet with chemical vapour resistant epoxy powder coated surface. Like all other products, these cupboards are also a tailor made product. A storage cupboard of any specific type, size, pattern can be made to the suit customer requirements.

Floor standing cupboard:

Made up of 1 mm thick Galvanised (GI) iron sheets finished with epoxy powder coating. Storage Chambers have multiple horizontal partitions with glass shutters. The glass shutters will have an aesthetic handles finished with epoxy / polyester powder coating and locking arrangements.

Wall cupboard:

Made up of 1 mm thick Galvanised (GI) iron sheets finished with epoxy powder coating. Storage chambers have multiple horizontal partitions depending upon your request and usage, with glass shutters. The glass shutters have aesthetic handles finished with epoxy / polyester powder coating and branded locking arrangements.

Floor standing heavy duty open rack:

Adjustable inner partitions provided which are made up of 1 mm and 2 mm thick Galvanised (GI) iron sheets and completely finished with epoxy / polyester powder coating.

Reagent storage rack:

Reagent rack for chemistry lab table. Standard two tire reagent rack made up of 1 mm thick Galvanised (GI) iron sheets and finely finished with epoxy / polyester powder coating. Standard dimensions: 650 x 250 x 600 mm ht. Non standard, customised sizes can also be made.

Chemical Storage Cupboard with an exhaust system:

Made up of 1 mm thick electro-Galvanised (GI) iron sheets finished with epoxy / polyester powder coating. Entire inner side is lined with PP sheet to protect the surface from corrosive vapours. Required fixed inner partitions will be provided as per customers requirements. Shutters will be provided with air holes and PP sheet lining. Shutters are made up of 1 mm thick Galvanised (GI) iron sheets finished with epoxy / polyester powder coating. Handles and locking arrangements are provided. Ducting with inline exhaust motor can be provided based on requirements.

LABORATORY FUME HOODS

Types of Fume Hoods available with us

Each lab's requirements are unique and customised provisions required. Metrolabs provides a variety of fume hood sizing options to suit every laboratory need.

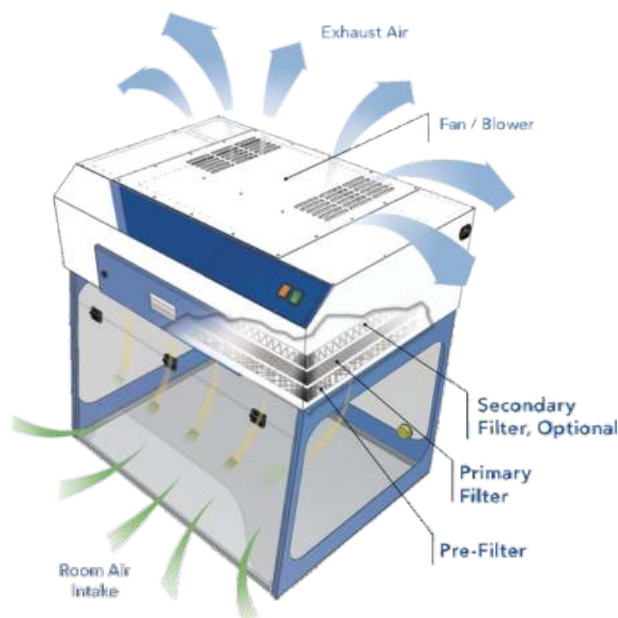

DUCTLESS FUME HOODS

A Ductless fume hood uses carbon filters to remove fumes and vapours from a laboratory. Carbon filtration, an advanced technology used within a ductless fume hood, is an eco-friendly choice for both the user and the environment. Instead of funnelling the fumes outside, the fume hood filters out the harmful fumes and then returns the clean air back into the laboratory. Ductless fume hoods are also energy and cost efficient and even offer electronic monitoring in order to routinely test the performance of the filtration system.

More Info

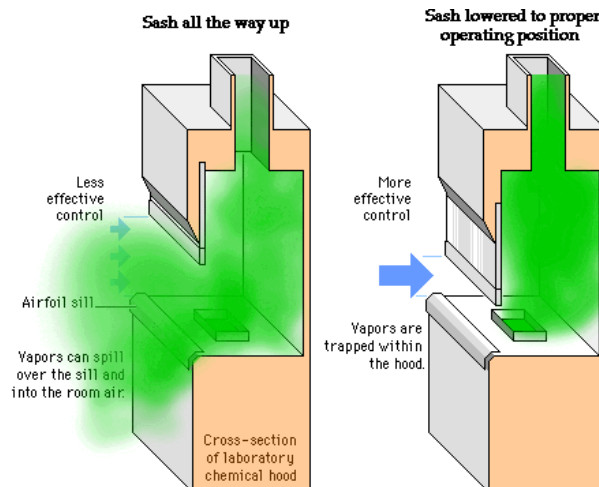

CHEMICAL FUME HOODS

A Chemical fume hood is used in laboratories where dangerous chemicals are handled in the workplace. This type of hood is specifically designed to allow laboratory workers to work with these chemicals without exposing themselves to the harmful drawbacks associated with them. Featuring quality steel and a design that exceeds SEFA standards, this unit will ensure workers can work with chemicals safely. The innovative design of the fume hood allows users to have a full view of their work and laboratory through a sash.

More Info

LABORATORY FUME HOODS



ACID RESISTANT FUME HOODS

Acid Resistant Fume Hoods (Perchloric/ Nitric/ Sulphuric/ Hydrochloric) Fume Hood is designed specifically to be used with perchloric acid in order to prevent perchlorate salt formations. These steel devices feature a bench top and are available in a variety of widths in order to fit any lab environment. The grade of steel used in the design of Perchloric Acid Fume Hoods provides the ultimate protection from the perchloric acid.

All-metal fume hoods, standard in most labs, will rust over time and need to be replaced, but specialty labs working with acids to break down organic and inorganic materials often make the mistake of not using metal-free fume hoods. Hydrochloric acid, sulfuric acid, hydrofluoric acid and nitric acid are common in any digestion experimentation and analysis, all of which will immediately rust and corrode any exposed metal it touches, resulting in contamination to samples.

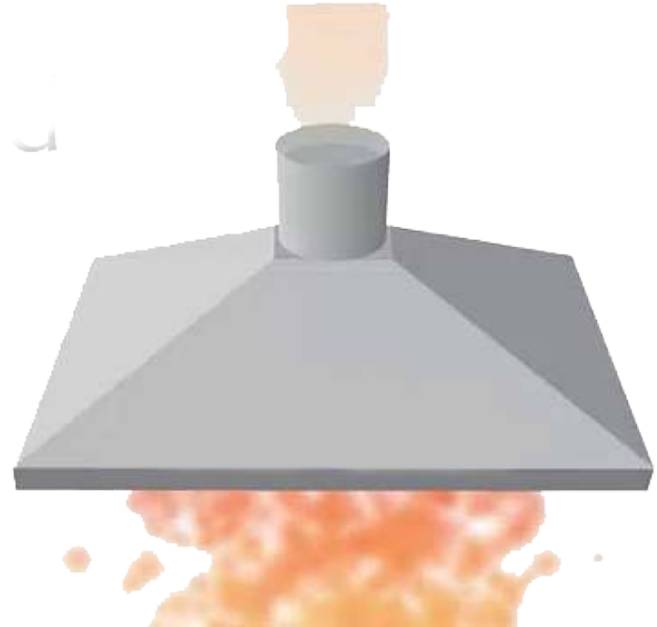

CANOPY FUME HOODS

Canopy Fume Hoods are designed to vent non-toxic materials such as heat, steam and odors from large or bulky apparatus such as ovens, steam baths and autoclaves. Our canopy hoods are either wall-mounted or suspended from the ceiling; some have a built-in baffle to increase air velocities and enhance the overall capture efficiency. Most canopies are off-white epoxy-coated steel.

While there are standard sizes for canopy fume hoods, your hood can be fabricated to your specific size requirements. Metrolabs canopy fume hoods are usually made from epoxy coated steel, but we can also make them using stainless steel T304 or T316 for more demanding environments.

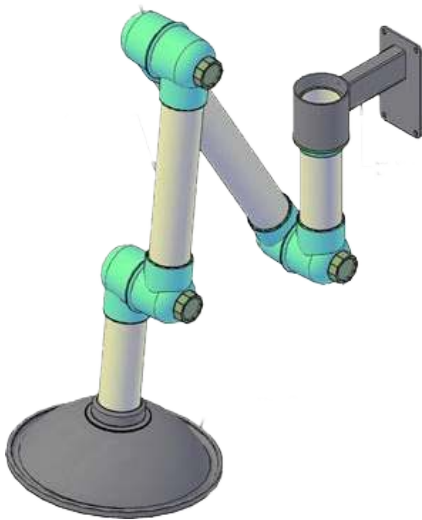

EXTRACTOR ARM FUME HOODS

Extractor Arm Fume Hoods are primarily used for local fumes, odors and air streams. The size of the arm is determined by the airflow that you need.

Our extractor arms feature a versatile bench, ceiling or wall mounting capability so you can place the arm where it suits you best. From self-assembly kits to tailor-made solutions, our arms are available in self-assembly kits, which include a fan and filter, a fan speed controller, hoses, table bracket and connectors. The kit provides a quick and convenient solution for creating a fume-free workplace.

Our benchtop extractor arms can be used in every type of environment, ranging from assembly stations, where solder fumes are extracted, to laboratories, where protection against highly corrosive or noxious gases is vital.

We can also help you to size a proper blower for your extractor arm fume hood.

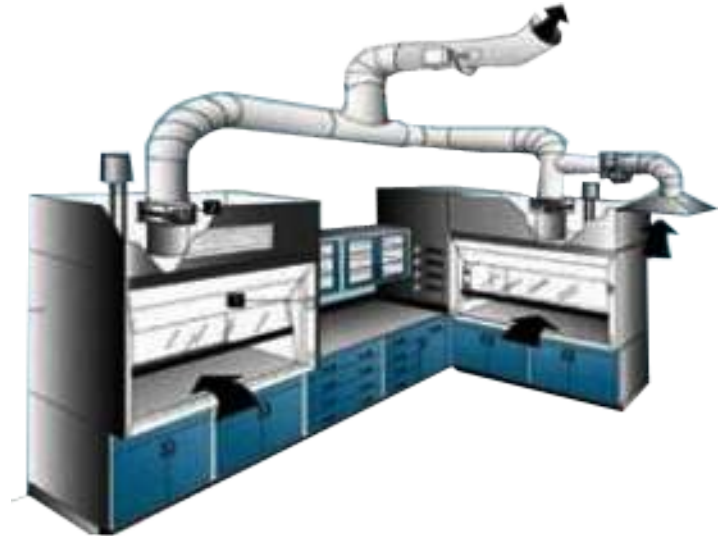

VARIABLE AIR FUME HOODS

The Variable Air Fume Hood is specifically designed for use with exhaust control systems provided by other manufacturers that monitor and control the amount of air being exhausted from the Hood. The use of these devices will maintain a constant face velocity and greatly reduce the operating cost of the Fume Hood.

A lintel at the upper front of the superstructure restricts the Hood air intake to the front sash opening. By incorporating any one of a number of commercially available VAV controls, the exhaust volume of the Hood can be varied to maintain a specified face velocity regardless of sash position.

LABORATORY FUME HOODS

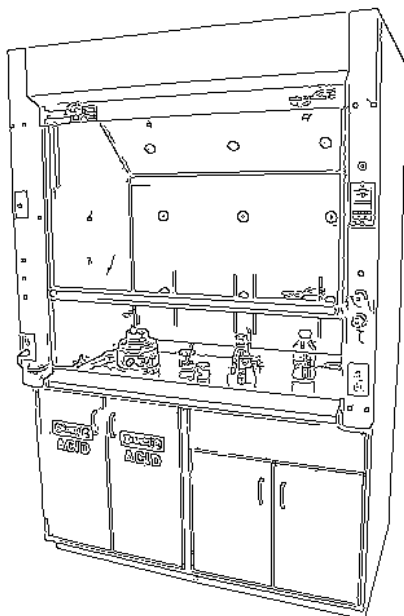

LOW FLOW FUME HOODS

You want to save as much as 40% on your energy bill long term. That's definitely a good enough reason to buy a low flow fume hood system. Low flow hoods can pass ASHRAE hood testing operating at approximately 60% of what a standard airfoil bypass hood operates at. This means smaller and less powerful blowers for you to purchase, maintain and replace.

It also means that you can reduce the amount of conditioned air that you have to pump into the room where your hoods reside. This means smaller air conditioners, furnaces and air handlers.

FUME HOOD ACCESSORIES

Common accessories include lab blowers, ventilation ducting in PVC, aluminum, stainless steel, sheet metal and lattice rod assemblies for distillation rack applications. Each accessory is specifically designed so the fume hood is easier to use for the lab worker and safer for the materials in the lab environment.

Fume hood accessories:

Gas / vacuum tap

Additional set of sockets

Stainless steel sink together with drain valve and mixer tap

Mixer tap for water supply (hot or cold)

Tap for water supply made of brass

Cabinet base with an air vent

Table top made of Polystone, Durcon . Can be produced in different size configurations.

Cabinet base of the fume hood is equipped by fixed supports and internal shelf for the reagents storing.



LED Display
Digital LED display:
Airflow Level



**Waterproof
Socket**



**Water Remote
Control**



Water Tap



Universal Wheel

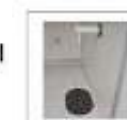

**Water Tap &
Water Sink**

LAMINAR AIR FLOW

Structure made 1mm thick GI sheet and Hollow CRCA tubing size of 40 x 20 x 1mm thick .Completely finished with epoxy powder coating technique.

Floor Standing Model:

Working Size: 3' x 2' x 2'; Overall Size: 1000 x 850 x 1950 mm; Retention particle size 0.3 microns; Noise level:65 decibel on "A" scale +/- 5; Velocity:90 feet minute +/-20; Front door: by 4 mm thick polycarbonate - foldable type; Lamp: UV; Illumination: Fluorescent tube fittings; Pressure: Inclined Manometer 0-50 mm range; Other accessories: 6/16 Amp Power point, Castor Wheels & Power chord; Power supply: 230 V, single phase, 50 Hz

HEPA Filter:

Media: Ultra clean glass fibre paper; Type: Mini-pleat HEPA filter, Separator less; Overall Size: 1000 x 850 x 1950 mm; Retention: 0.3 Micron with a Max. 25 mm WG; Efficiency: 99.98% / Grade H13 rating.

PRE Filter:

Structure made up of 40 x 40 mm square tube. Legs are covered with PVC cover with leveling screws. Cabinets MOC: Cabinets are made from Galvanized Iron (GI) 1 mm thick pre-coated Galvanized iron Sheet and completely finished with epoxy powder coating.

Colour combination of IVORY fronts contrasting for aesthetic appeal by powder coating technique.

Blower assembly: Outer rotor type blower system, which consists of dynamically & Statically balanced aluminium centrifugal impeller driven by a single phase motor, enclosed in an PU coated GI casting directly connected to the filter chamber.



Sulphuric acid
Hydrochloric Acid
Nitric Acid

Ammonia Solution
Hydrogen sulphide
Kipp's apparatus

BIOSAFETY CABINET

Class II B2 Biohazard Safety Cabinets provide personnel, product, and environment protection. Class II Cabinets differ in the proportion as 70% air is re-circulated within the cabinet through high efficiency particulate air (HEPA) filtration. Velocity of airflow to the work zone creates an ultra-clean environment for product protection, where the remaining exhaust air is discharged out. Air barrier at the work opening and the contaminated air plenum is under positive pressure. An air barrier between the operator and the work zone is maintained by a flow of room air through a full width grille in the work opening. The barrier air mixes with the laminar flow air in a sump underneath the work surface, and is exhausted to the outside environment through a HEPA filter. Maintains a minimum measured average inflow velocity of 75 fpm through the work area access opening. Minimum face velocity at the access opening varies between 80 fpm and 100 fpm depending on cabinet sash opening. Have HEPA filtered down flow air from a common plenum. (I.e. from which a portion of the air is exhausted from the cabinet and the remaining air is supplied to the work area).

Cleanliness Level : ISO CLASS 100 as per ISO 14644-1

Direction of Flow: Vertical; Air Balancing 100% exhaust; 0% circulation.; Particle Retention 0.3 Micron & above.; Inflow Velocity 100 FPM \pm 20; Down Flow Velocity 80 FPM \pm 20; Noise level 70 decibel on "A" scale \pm 5; Pressure Differential 0 - 50 mm Magnehelic Gauge; Ultra violet lamp PHILIPS - make Illumination Fluorescent tube.

Material of Construction: The Cabinet made from Galvanized Iron 18 SWG sheet metal with polyurethane paint coating finish and bottom will be supported with CRCA square with PU coated stand.

Support stand: under-bench support-stand made of 40 x 40 x 2 mm thick CRCA square tubes.

HEPA Filter: Media Ultra clean glass fiber paper - imported Supply Air & Exhaust.

Type Mini-Pleated constructions Retention 0.3 Micron Efficiency 99.97% Pressure drop 12 mm WG Grade H13 rating.

PRE Filter: Media Non woven - synthetic polyester Retention 10 - 15 micron Efficiency 90% Pressure drop 6 mm WG



metrolabs1@gmail.com

CHEMICAL STORAGE CUPBOARD



Made of 20 Gauge G.I. Electro-Galvanized sheets finished in powder coating. Storage Chamber will have 1 fixed horizontal partition with 4 shutters.

Inner skin in 3mm thick. PP construction sheet on shelves. It will increased chemical resistance and it is exclusively formulated to resist the acids, bases, and solvents often used in laboratories. Special arrangement for ventilation.

Duct damper in PVC / PP construction. The Shutters will be provided air holes with aesthetic handles finished with epoxy powder coating and branded locking arrangements.

LAB FURNITURE COUNTER TOPS



Granite



Phenolic Resin



Epoxy Resin



Ceramics

GRANITE: granite countertops can go much longer than this list, we've narrowed it down to the best-of-the-best granite perks that are sure to impress. Check it out!

Granite countertops are long-lasting stone to serve as the backdrop for all of your laboratory researching, testing, life lessons, we know granite countertops can handle it all. With so many granite perks, this countertop choice is our go-to recommendation for your renovation. From the incredible durability to a range of unique slabs and the instant value increase in your home, you can't go wrong with a granite countertop.

SCRATCHING & CHIPPING RESISTANCE; GRANITE IS EASY TO CLEAN; HIGH AFFORDABILITY; RESISTANCE TO STAINS, HEAT, AND MOISTURE; GRANITE COUNTERTOPS ARE PERFECTLY FLAT; IT ADDS VALUE TO YOUR LABORATORY; GRANITE IS USER-FRIENDLY; EACH GRANITE SLAB IS UNIQUE

EPOXY: Epoxy Countertops can hold up to just about anything you will do in your lab. The product is a solid homogeneous material throughout, meaning that the outside color exists all the way through the entire product. Epoxy countertops are heavy-duty and nearly indestructible.

PHENOLIC RESIN: Phenolic Resin countertops might be used in the biological, chemical, clinical or analytic laboratory setting. It is available in three finishes: white, silver-grey, and black. Phenolic can also be used for other surfaces such as tops, shelving, window sills, and even custom trough sinks.

STAINLESS STEEL: Stainless steel countertops are known for their beauty and light reflection. They give your lab a uniform look, with sinks, companion shelving, and backsplashes available. Best used in pharmaceutical labs, food testing, hospital, medical or chemical labs.



Stainless Steel



Wood



Glass



Laminate
www.metrolabs.biz

SOME IDEAS FOR LAB

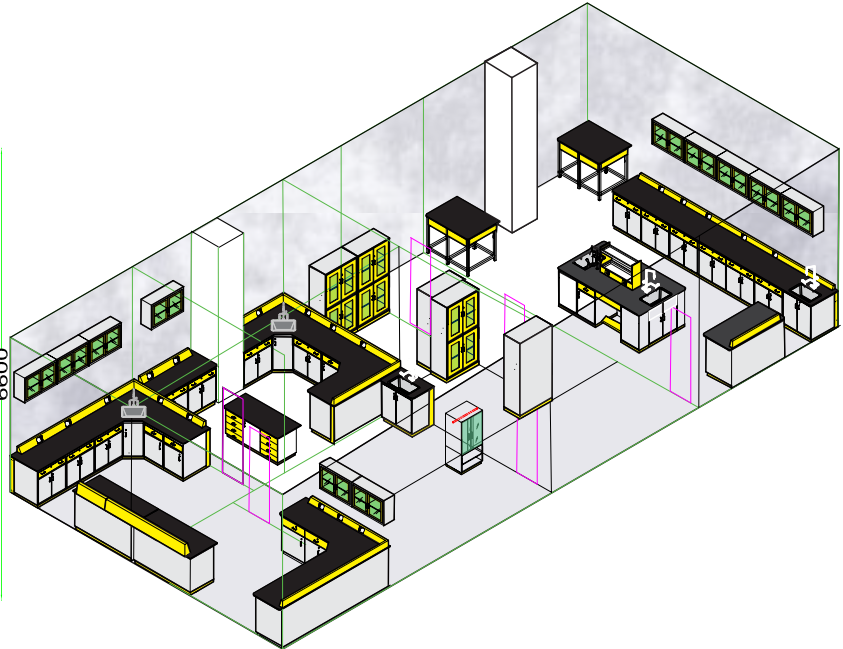
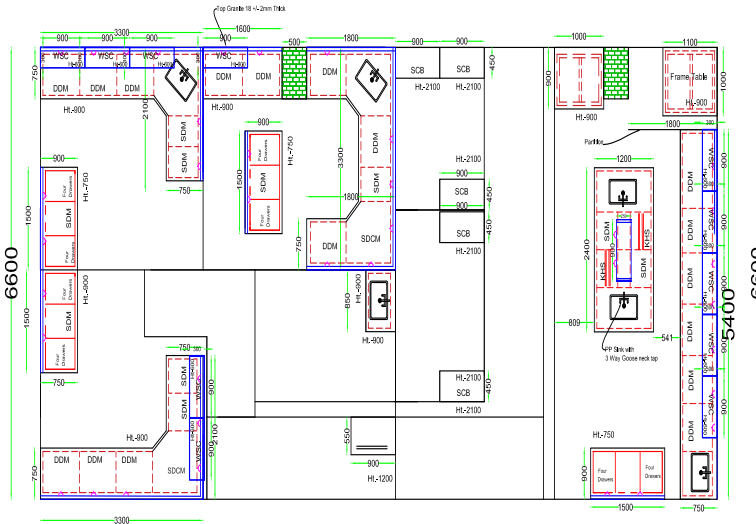
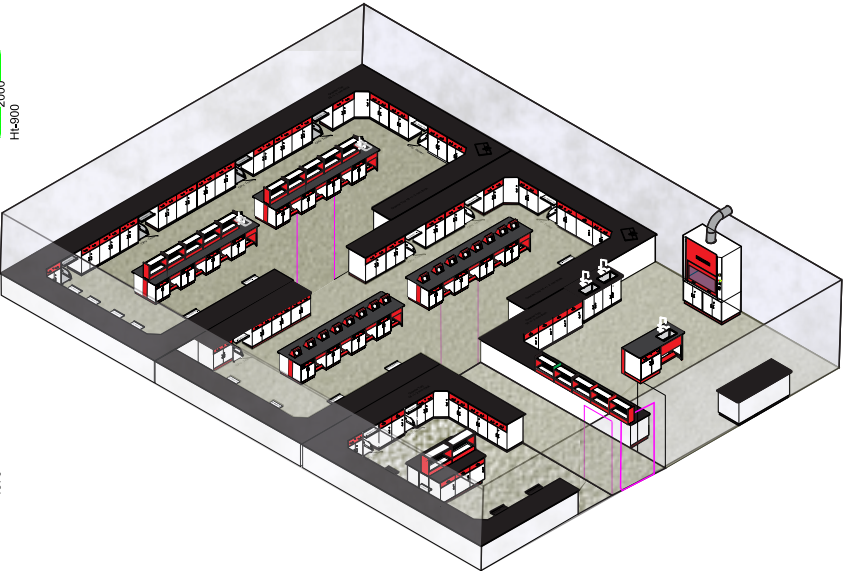
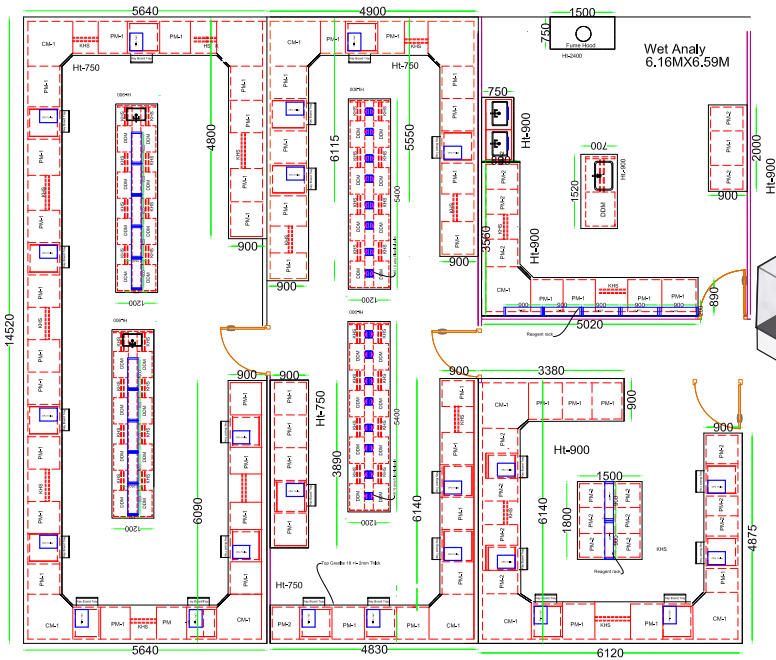

LAB FURNITURE MAINTENANCE

Work top cleaning: Clean the table surfaces using a general purpose detergent and warm water. After each cleaning, wipe with a clean, dry cloth. Clean the work tops according to a regular schedule, with spot cleaning as needed. Sand surfaces carefully when appropriate. Use the right cleaning methods and products. Use appropriate finishing agents.

Under bench module cleaning: Clean under bench modules with clean cloth soaked with distilled water followed by wiping with a dry clean cloth. Do not use any cleaning agents.



DO'S

- Cleanup liquid and dry spills immediately.
- Protect the feet of lab apparatus with rubber, felt or a protective pad.
- Place a trivet under all hot containers and components.
- Extinguish all flames on the work surface.
- Apply a thin coat of finish oil or Murphy's oil periodically on granite work top surfaces.
- Educate all users for the proper care of work surfaces / tops.

DON'TS

- Do not drag items across the surface.
- Do not cut, chop or strike items directly on the surface.
- Do not drop items onto the surface.
- Do not use abrasive sandpaper or metallic scouring pads on work surfaces or sinks.
- Do not store chairs on the work surface without a protective covering such as cardboard.

- Do not melt dry ice with hot water directly on the surface or in the sink as the thermal shock may break the joints or cause the sink to fracture.
- Do not wax the surface (or use polish containing wax).

BASIC LAB SAFETY RULES

Know emergency exit routes. Avoid skin and eye contact with all chemicals. Minimize all chemical exposures.

Assume that all chemicals of unknown toxicity are highly toxic.

Avoid distracting or startling persons working in the laboratory.

Combine reagents in their appropriate order, such as adding acid to water.

Do not taste or intentionally sniff chemicals. Never consume or store food and beverages. Never apply cosmetics in lab.

Wash the exposed areas of the skin prior to leaving the laboratory.

Long hair and loose clothing must be pulled back and tied.

Lab safety goggles and gloves should be worn in chemistry lab.

Avoid wearing jewellery in the lab as this can pose multiple safety hazards.

Clothing made of synthetic fibres should not be worn while working in lab.



Please visit our stall at major exhibitions!



METROLABS

Lab Furniture | Fume Hood | Laminar Airflow | Storage Cupboard

We are there when you need us !

www.metrolabs.biz

**Chennai | Bengaluru | Pune | Hyderabad | Vizag
Delhi | Bhubaneshwar | Kolkata**

metrolabs1@gmail.com

+91 98409 31231 | 98409 31233 | 97910 33312

Call us

www.metrolabs.biz

for all your
laboratory furniture needs !

98409 31231



A complete solution for **Laboratory Furniture** suitable for any curriculum.